

skating®



DECEMBER 1980

Riedell



THE QUALITY BOOT

RIEDEL SHOES, Inc., Red Wing, MN 55066 • 612/388-8251

(Circle No. 1 on reader service card)

skating®

VOL. 57 NO. 10

DECEMBER 1980

Contents

FEATURE ARTICLES

- Ladies In Waiting 15
by Mary Ann Purpura
- Simone Grigorescu: A New Home, New Hopes 16
by Karelei Tulenko
- Sandy Lenz: The Girl Who Won't Come Down 22
by Vicki Kurzrock
- Elaine Zayak: Serious Senior 25
by Karelei Tulenko
- Tiffany Chin: San Diego's Good Luck on the Ice 30
by Gloria Williams
- A Skating Collector's Dream 33
by Mary-Lucile Ager

REPORT

- 1980 USFSA Board of Directors' Meeting 36
by Ruth L. Jackson

DEPARTMENTS

- | | |
|-----------------------------------|---------------------------------|
| Ice Abroad 5 | Kid Talk 60 |
| Calender of Events 7 | Classifieds 62 |
| People, Places, Faces 9 | Non-Qualifying 64 |
| Laurels 41 | Advertisers' Index 66 |

NEXT MONTH

Profiles of men's singles, including Scott Hamilton, David Santee, and Allen Schramm.

THIS MONTH'S COVER

1980 U.S. Bronze medalist, Sandy Lenz, is one of several "ladies-in-waiting" for the opportunity to win a National title in San Diego in February.

Photo by: David Leonardi.

COPYRIGHT: SKATING, copyright 1980 by the United States Figure Skating Association (USFSA). Title registered in the U.S. Patent Office. SKATING is protected by copyright, and nothing that appears in it may be reproduced without written permission. The USFSA is not responsible for statements or opinions in this magazine.

ISSN: 0037-6132.

skating

ICE ABROAD

ST. IVEL INTERNATIONAL

—Dennis L. Bird

EDITOR

Ian A. Anderson

ART DIRECTOR

Shawn Doherty

ADVERTISING/PRODUCTION

Mary Ann Purpura

SUBSCRIPTIONS

Cynthia L. Nesselhauf

Correspondents

Betty Ann Bagley — Canada

Howard Bass — U.K.

Dennis L. Bird — Germany

Nigel Brown — Switzerland

Per Cock-Clausen — Denmark

Eva Gyorgy — Hungary

Junko Hiramatsu — Japan

Frank Loesser — Canada

Rev. Kevin Reynolds — South Africa

Advertising

Rate card supplied on request. SKATING and the USFSA neither endorse nor take responsibility for products or services advertised herein.

SKATING (ISSN: 0037-6132) is published by the United States Figure Skating Association, 20 First Street, Colorado Springs, CO 80906. Phone (303) 635-5200. Subscription rate: United States, one year \$7.50. Canadian and foreign, one year \$17.50. Second Class postage paid at Colorado Springs and at additional mailing offices. SKATING is published monthly October through July (10 issues per year). Copyright 1980 by The United States Figure Skating Association (USFSA). **Postmaster: Please send FORM 3579 to SKATING, 20 First Street, Colorado Springs, CO 80906.**

USFSA President — Oscar T. Iobst, Jr.

SKATING is the official publication of the United States Figure Skating Association (USFSA).

The third Ice International at Richmond, England (sponsored this year by St. Ivel cheese instead of Rotary Watches) took place from September 29 to October 2, and attracted forty-two competitors from ten countries. Two other entrants were unable to skate—the Czech, Miroslav Soska (injured), and the Austrian lady champion Claudia Kristofics-Binder, who was in the hospital with a fever.

Past winners of the Richmond Ice International have included Linda Fratianne, Robin Cousins, Krisztina Regoczy and Andras Sallay. Now that there have been the usual post-Olympic retirements, many younger skaters were hoping for success at Richmond as a stepping-stone to similar European or World championship fame.

The men's event included three who are likely to be vying for World top honors at Hartford, Connecticut—Scott Hamilton (USA), Brian Pockar (Canada), and Fumio

Centre Ice

FIGURE SKATING BOUTIQUE

Exclusive figure skating shop featuring every possible item for your skating needs.

S.P. Teri, Riedell & Oberhamer Boots
M.K. & Wilson Blades

Skating fashions by Inga & Action Wear
Polar Sport apparel • Scribes

Send for your FREE catalog & price list. . .
Phone orders welcome! We accept VISA & MASTER CARD.

CENTRE ICE Figure Skating Boutique
1730 Pflingsten Rd. Northbrook, IL 60062
(312) 272-4330

(Circle No. 2 on reader service card)

Igarashi (Japan). Scott who is a remarkable example of the medical value of skating (it helped him overcome a serious childhood illness), was easily best in figures and was placed first by all seven judges. Brian Pockar was second, although outskated by the Japanese champion on the final back paragraph-loop figure.

After the short programs, the Pennsylvanian was still in the lead although beaten in that part of the event. Incidentally, the old system of determining results was still in force, so a big lead in figures was a help. Scott tried a difficult combination of triple lutz and double toe-loop; he did the lutz but fell on the loop. Brian Pockar's double Axel was not quite steady, but he did a fine triple toe-loop/double loop combination, and won this section. Fumio Igarashi did a simpler combination, and fell later in his program, while Igor Bobrin (a real veteran at twenty-six) sat down on his double lutz and never looked in contention. A surprise was the excellent performance of Norbert Schramm (West Germany), third in the short program, who seemed inspired by his music, "Hold that Tiger."

On the third day, it was the twenty-one-year-old from Tokyo who proved best. Fumio Igarashi won this title in 1978 and went all out to repeat history. He did not quite succeed, but he gave a fine show, including four triple jumps. The other competitors all seemed off form; perhaps it was too early in the season to expect new programs to be working at their best. Scott Hamilton opened brilliantly with a triple lutz, but fell immediately afterwards on a triple toe-loop. A triple Salchow later was faulty, but fast steps, a flowing style, good use of the music, and some fine combination jumps made this look like the sort of program that with practice could be a world-beater. Brian Pockar stumbled on a double lutz, but jumped well otherwise, to take second place in the long programs and first place overall, by four judges to three.

In the ladies' event, the leader in figures was similarly not the final winner. The delightfully extrovert Canadian, thirteen-

RESULTS OF THE ST. IVEL INTERNATIONAL

LADIES'		ORD.
1. Sandy Lenz, USA		8
2. Tracey Wainman, Canada		16
3. Sanda Dubravcic, Yugoslavia		22
4. Svetlana Frantsuzova, USSR		24
5. Andrea Rohm, Austria		38
6. Karen Wood, Britain		39
7. Alison Southwood, Britain		49
MEN'S		ORD.
1. Brian Pockar, Canada		12
2. Scott Hamilton, USA		11
3. Fumio Igarashi, Japan		19
4. Norbert Schramm, W. Germany		31
5. Igor Bobrin, USSR		35
6. Andrew Bestwick, Britain		42
7. Christopher Howarth, Britain		46
PAIRS'		ORD.
1. Barbara Underhill & Paul Martini, Canada		7
2. Inna Volanskaia & Valeriy Spiridonov, USSR		21
3. Susan Garland & Robert Daw, Britain		18
4. Sheryl Franks & Michael Botticelli, USA		28
5. Lorri Baier & Lloyd Eisler, Canada		31
6. Dawn Packer & Ian Jenkins, Britain		42
DANCE		ORD.
1. Jayne Torvill & Christopher Dean, Britain		7
2. Elena Garanina & Igor Zavoizin, USSR		16
3. Karen Barber & Nicholas Slater, Britain		21
4. Kim Krohn & Barry Hagan, USA		27
5. Kelly Johnson & Kris Barber, Canada		34
6. Anna Pisanska & Jiri Musil, Czechoslovakia		43
7. Birgit Goller & Peter Klisch, W. Germany		48
8. Regula Lattmann & Hans-Peter Muller, Switzerland		56

(Continued on page 6)

Ice Abroad (Continued from page 5)

year-old Tracey Wainman, skated some confident figures which were clearly best. She finished each one particularly well, not just sliding off as many skaters do, but adopting a brief, elegant pose to show that the figure was finished. Sandy Lenz showed a remarkable ability to get around the figures neatly and smoothly after the gentlest of push-offs. Sanda Dubravcic took third place, but was second on the back paragraph loops.

The girls all seemed nervous in the short programs the next day. Miss Lenz's beautiful style and musical interpretation made her a joy to watch, but her combination was a double Axel/single loop instead of the required double. Miss Wainman also failed on the combination, while Miss Dubravcic, after succeeding with a triple toe-loop/double loop, then marred her performance with a fall on a double Axel.

The long free was a triumph for Miss Lenz. Looking relaxed and happy, she glided through her program, with feather-light landings to high and well-controlled jumps. In the overall results, she was first on all but one judge's card. The exception was the British judge, who preferred Miss Wainman. The little Ontarian's program was beautifully presented, but she fell on a triple toe-loop and again later. It was just not her night—but what talent she has! Equal second with Tracey in the long free was the seventeen-year-old Leningrad skater Svetlana Frantsuzova, who was sixth in the 1979 Junior World Championships.

The ice dance event was a runaway victory for the British champions Jayne Torvill and Christopher Dean. At the end, their total score was more than ten points ahead of their nearest rivals—an enormous lead. Miss Torvill was once British pair-skating champion, but with Chris she is now clearly on the way to becoming one of the World's top dancers. The Russians, Elena Garaninga and Igor Zavoizin from Leningrad, stayed firmly in second place throughout, with Britain's second team Karen Barber and Nicholas Slater third. Kim Krohn and Barry Hagan from Califor-

THE MARTIN SCRIBE

- Scribes accurate circles and loops
- Telescopic fold-up construction
- Stainless steel hinge
- Anodized Alcoa® aluminum
- Warranted for one full year

\$50.00 plus 2.50 shipping Ohio residents add 4 1/2 % tax

Send for complete brochure
Dealer inquiries invited

Martin & Company

P.O. Box 18174
Cleveland, Ohio 44118

(Circle No. 3 on reader service card)

nia were fourth. The event was enlivened by the cha-cha-cha rhythm which has been chosen this season for the original set-pattern dance. The biggest sensation occurred when the skating was over; three days later came the news that the Czech dancers Anna Pisanska and Jiri Musil, who had finished sixth, had declined to go home. Instead, they have been granted political asylum in Britain.

The pairs' event was dominated by the Canadian champions Barbara Underhill and Paul Martini. Their strong style and dramatic twist-lifts put them in a class by themselves. Second place was fiercely contested by the Russian pair and the British champions, Susan Garland and Robert Daw. Inna Volanskaia from Moscow fell on a double jump and stumbled on a throw, and with her partner Valeriy Spiridonov skated to ugly, raucous music. The judges were evenly divided in awarding second place; three judges voted for Britain, three for the USSR. The American judge tied them—but her vote went to the Russians because she gave them 0.2 more for free-skating. It was a tight finish. Fourth were the excellent U.S. pair Sheryl Franks and Michael Botticelli.

About two hours of the competition was televised over three nights, with commentaries by Alan Weeks and the Olympic champion Robin Cousins. The St. Ivel International was a successful meeting, and some of the competitors are likely to make an even bigger mark on the world scene soon.

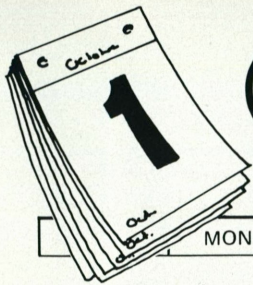

CALENDAR of EVENTS

MON.	TUES.	WED.	THUR.	FRI.	SAT.
------	-------	------	-------	------	------

DECEMBER

- 4-7 **4th Annual Christmas Pops on Ice**, starring Dorothy Hamill, sponsored by the Broadmoor SC at the Broadmoor World Arena. For information call 303-634-7711 Ext. 5256.
- 13 **4th Annual Christmas Exhibition**, sponsored by the Great Lakes FSC at the Ford Woods Ice Arena. For information contact: K.W. Leedy, President, Great Lakes FSC, 14900 Ford Road, Dearborn, MI 48126, 313-278-8625.
- 14 **Holidays On Ice**, carnival sponsored by the Cornell FSC, at the Lynah Rink, Cornell University, NY. For information contact: Gail Kramer, 607-272-8158.
- 21-22 **Joy to the World, A Fantasy on Ice**, guest stars Susan Garland and Robert Daw, Great Britain, sponsored by the Northcross FSC at the Ice Rink at Northcross Mall, Austin, TX. For information contact: Meg Pappas Goodman, 512-451-5103.

1981

JANUARY

- 23-25 **First Annual Garden City FSC Competition**, sponsored by the Garden City FSC, at the Garden City Civic Arena, Garden City, MI. Figures and Freestyle from Preliminary through Novice. For information contact: Sylvia McMahon, Registration Chairman, 31781 Bock, Garden City, MI 48135, 313-427-2790.

FEBRUARY

- 11-14 **Third Annual Tri-Cities Winter Championships**, sponsored by the Tri-Cities FSC, at the Ice Chalet - Forum 303, 2800 E. Pioneer Pkwy., Arlington, TX 76013. Non-qualifying figure, free skating, pairs and dance competition for beginners through seniors. For information contact: Mrs. Reed St. Pierre, 718 Meadows Pkwy., De Soto, TX 75115 or Mr. Ira Scott, 2534 Sunnyvale, Grand Prairie, TX 75050, 214-223-3242 or 214-641-1614.

- 13-15 **Colorado Mid-Winter Invitational**, sponsored by the Pueblo FSC, at the Pueblo Plaza Ice Arena, 100 N. Grand, Pueblo, CO 81001. Free skating Competition. For information contact: Mrs. Marlene Sullivan, 2115 Elmwood Ln., Pueblo, CO 81005, 303-564-3982.
- 14 **Ice Time**, show sponsored by the SC of Lake Placid, at the Olympic Arena, Lake Placid, NY. For information contact: Beverly Lalonde, 25 Forest, Saranac Lake, NY 12983, 891-3434.
- 14 **Tri-State International Precision Team Competition**, hosted by the Kent SC at the Kent State Ice Arena, Kent, OH. For information contact: Lori Hodgkin, KSU Ice Arena, Loop Road, Kent, OH 44242, 216-823-3175.
- 15 **Winter Carnival Ice Show**, sponsored by the SC at Dartmouth College, Hanover, NH. For information contact: Mrs. David Osborn, Box 87, Norwich, VT 05055, 802-649-1981.
- 21-22 **3rd Annual Winter Warmup Open Championships**, sponsored by the Harbor FSC of La Mesa, CA. For information, phone 714-560-0424 or write P.O. Box AH, Lemon Grove, CA 92045.
- 22 **"Fantasy on Ice,"** 14th annual ice show, sponsored by the Bemidji FSC, at the John Glas Fieldhouse, Campus of Bemidji State University. For information contact: Gordon McClellan 218-751-2695.
- 22-23 **Southland Theatrical Competition**, sponsored by Palomares FSC, at the Southland Rink, Hayward, CA. This competition is open to both USFSA and ISIA skaters under a joint sanction. For information contact: Martha S. Hanson, 1603 Eve Dr., Concord, CA 94521.
- 28-3/1 **Marquette International Open Figure Skating Competition**, sponsored by the Marquette FSC, at the Lakeview Arena, Marquette, MI. Free Style Competition. For information contact: W. Robert Hampton, 1512 Lynn Ave., Marquette, MI 49855, 906-228-6678.

(Continued on page 59)

Inga's makes me feel this good!



INGA
Creations

Call or Write for Free Catalog

7075½ Vineland Ave., No. Hollywood, Ca. 91605 (213) 982-0616

People, Places & Faces

People, Places & Faces

Photo by: Mary Ann Purpura

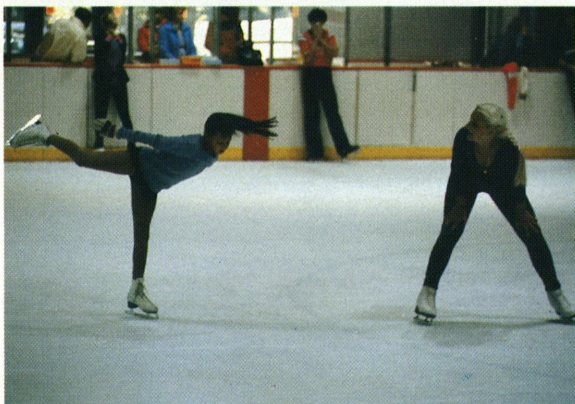

Lisa-Marie Allen took some time out to help Italy's Pinuccia Ferrario with her camel spin.

BROADMOOR SKATERS SPEND WEEKEND TRAINING IN VAIL

What do you do when your home ice suddenly becomes unavailable? Well, you might pack up your skates, grab your scribe and head for the hills as the skaters from the Broadmoor World Arena did recently when they found their ice had temporarily become a convention site. The hills in this case, however, were the Rocky Mountains that surround the ski resort of Vail, Colorado. Special rates for the skaters were arranged with the Kiandra-Talisman Lodge; and for three mornings the second floor of the Lodge resounded with the sounds of ringing alarm clocks rousing the skaters for the five o'clock patch, and their whispering to each other to be quiet so as not to awaken everyone else.

Ice time had been reserved at the John Dobson Arena (the home of the SC of Vail). The skaters were divided into groups and patch and freestyle schedules were posted for each group. Although accustomed to skating at the altitude of 6,000 feet, the Broadmoor skaters soon found training at the additional 2,000 feet at

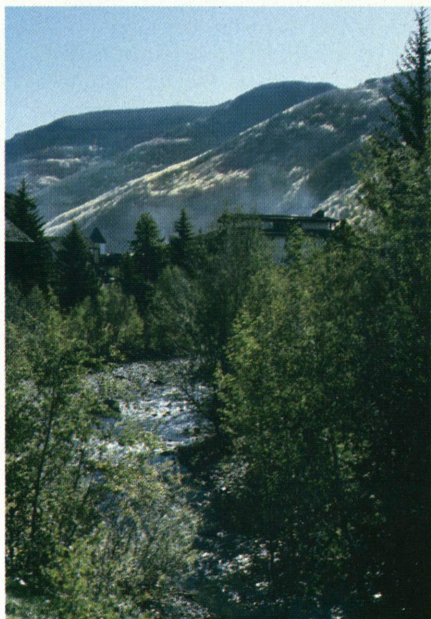

Photo by: Mary Ann Purpura

The view from Vail's Kiandra-Talisman Lodge.

Vail, combined with expanded ice time, more fatiguing than usual. Among the skaters who participated in the Vail training sessions were Lisa-Marie Allen, James Cygan, Allen Schramm, Scott Thompson, Larry Schrier, Tricia Burton, Dana Graham, Kelly Webster, Eddie and Mary Lu Shipstad, and Missy Becker. Skaters from Sweden, Italy, Japan, England, and Finland also took advantage of this opportunity to train at a higher altitude. Training sessions were supervised by coaches, Barbara Roles, and Helen and Bob Maxson.

When not on the ice, skaters and coaches enjoyed the gorgeous fall colors of the aspen, browsed through the shops in Vail Village, dined at fabulous restaurants such as Pepi's, and boogied the night away at the Shadows Disco.

WINTER WORLD UNIVERSITY GAMES ANNOUNCED

Word has been received from Federation International Student Universiada (FISU) and the Organizing Committee of the Winter World University Games that these Games will be conducted in Jaca, Spain from February 23–March 4, 1981. Sports to be on the competition calendar are: Skiing (Alpine, Nordic, Jumping), Ice Hockey, and Figure Skating.

The United States Collegiate Sports Council (USCSC), as the franchise holder in the United States for all FISU events, is eligible to field teams in all these sports. For information pertaining to student/athlete eligibility and criteria for USCSC participation in FISU events, contact Glen Davies, Executive Director, Suite 102, KCKCJC, 7250 State Avenue, Kansas City, Kansas 66112, Phone: 913-788-5885.

A NOTE FROM THE COMPETITIONS COMMITTEE

All skaters selected and who represent the United States in International Competition held after October 25, 1980 will be granted permission to go directly to their Sectional Championships in the same event in which they skated without qualifying through their Regional Championships.

—*Joseph L. Serafine*
Competitions Chairman

LISA-MARIE ALLEN SUPPORTS MS READ-A-THON

Lisa-Marie Allen, 1980 U.S. National Silver Medalist, is the celebrity chairman of the Southeastern Colorado Chapter of National Multiple Sclerosis Read-a-thon program.



LISA-MARIE ALLEN

Lisa-Marie, who placed fifth in the 1980 Olympic women's competition, will send postcards to school children participating in the read-a-thon. She will perform at the awards program for the read-a-thon winners in December.

Children participating in the read-a-thon volunteer to read books during a four-week period and persons pledge a certain amount of money for each book read.

BIRTHS...

To proud parents, **Charles E. and Mary Karen (Campbell) Henderson**, a son, Charles Campbell Henderson, on September 2, 1980. Mary Karen was the 1973 National Gold Dance Champion with her partner, Johnny Johns.

People, Places & Faces

MARRIAGES...

Carol Randolph, member of the Queen City FSC and USFSA gold medalist in dance, was married to Anthony Buen on August 2, 1980, near Cincinnati. They are residing in Westville, New Jersey.

BEREAVEMENTS...

In Memorium

Mr. Edward O'Brien, a National Figure Judge and Silver Dance Judge, passed away on October 9, 1980. Mr. O'Brien was a member of the Chicago FSC since 1932 and will be sadly missed.

Mrs. Warren Guibor of the Gateway/St. Louis FSC recently passed away. Carolyn was extremely dedicated and devoted much time to club activities as board member and test chairman. She was the mother of competitive skaters, Judy and Linda. Mrs. Guibor will be greatly missed by all.



RULEBOOK UPDATE...

Please note the following changes in your Rulebook:

NEW ADDRESSES

The Salt City Figure Skaters
P.O. Box 6066
Syracuse, NY 13217

Winifred H. Treadwell
1140 Blvd. de Palmas
Marathon, FL 33050
305-743-2359

DOES YOUR CLUB HAVE A CUSTOM CLOISONNE ENAMEL TEAM PIN?



Discover an easy fundraising idea and profits for your club! Guaranteed workmanship, fast service, Manufacturer of medals and pins.

Product line carries: © Pin Pals Character Pins, 1980 Moscow Olympic Pins

WRITE NOW

for free literature and samples to:

Designs by Margarita
18103 Santa Cecilia Ave.
Fountain Valley, CA 92708

Please provide:



Name of Organization: _____

Address _____

Zip _____

Project Description _____

(Circle No. 5 on reader service card)

Robert J. Hoven
719A South St.
Philadelphia, PA 19147

Ronald T. Pfenning
Board of Directors
339 B. Sea Street
Hyannis, MA 02601

J.J. Kohlhas, Jr.
411 Lark Drive
Apt. 5
Carmel, IN 46032
317-848-7620

Mrs. Richard J. Binette
Judging Records & Amateur Status
Committee
503 Partridge Road
Hoyt Lakes, MN 55750
218-225-2038



M & M Distributors/The Ice Box

A & B come in T-Shirts only, \$6.95 ea.
 C in T-Shirts \$ 6.95 / Sweatshirts \$ 11.95
 D in T-Shirts \$8.95 / Sweatshirts \$ 12.95

Sizes:
 Children, Sm., Med., Lg.
 Adult, Sm., Med., Lg., Xlg.

\$1.50 handling for 1 item, \$ 2.50 for 2 or more items.

Send to: **M & M Distributors**
 15081 Syracuse Street
 Westminster, CA 92683

(Circle No. 6 on reader service card)

Official Notes (Continued)

Carol Jean Fox
 913 C. Cloister
 Wilmington, DE 19809
 302-798-7404

Richard John Dalley
 1919 Shipley
 Wilmington, DE 19803
 302-654-9222

Ron Ludington
 416 Shipley Road
 Wilmington, DE 19809
 302-764-4077

Marie Pearce
 Judges Committee – South Atlantic
 1310 Youngsford Rd.
 Gladwyn, PA 19035
 215-649-5565

William V. Colway
 Membership Committee
 431 So. 150 Circle
 Omaha, NE 68154

CORRECTIONS TO 1980–81 USFSA RULEBOOK. . .

Junior Competition and Gold Dance Test Judge, John LeFevre's address was listed incorrectly in the 1980–81 Rulebook on pages 228 and 233. The correct address is:

John LeFevre
 8016 Falstaff Rd.
 McLean, VA 22102

On page 219, the phone number listed for Jean and Roy Winder is incorrect. Their correct home phone number is (303) 471-8352.

Betty Sonnhalter should be added to the Sanctions Committee.

Also, the figure groups for Intermediate Group 3, on page 38, were listed incorrectly; they should be 10, 26, 14.

NEW CLUB. . .

The USFSA extends a warm welcome to the Nashville FSC, a new addition to our association. The Nashville FSC's address and officers are listed below:

Nashville FSC
 Ice Centennial
 23rd & Leslie Avenue
 Nashville, TN 37203

Bob Sibert, President
 1408 Breckenridge Ct.
 Nashville, TN

Amy K. Gilmore, Secretary
 320 Welch Road
 Nashville, TN 37211

JUDGES APPOINTMENTS. . .

LOW FIGURE
 Jack Searle, Utah FSC
 Christina Bahret, Hickory Hill FSC
 Linda Palmer, Olde Monmouth SC
 Thomas Milligan, Atlanta FSC
 Lawrence Kriwanek, All Year FSC
 Ken Flora, Portland ISC
 Robert Bolton, Detroit SC

(Continued on page 58)

In Memorium
JACQUES FAVART
1920 – 1980



Jacques Favart, President of the International Skating Union, died on September 27, 1980. His untimely death is a tragic loss to the world of amateur ice skating and all its participants.

All of those who had the privilege of working with him, held him in the greatest respect and affection. He was intelligent, fair, honest, forceful, innovative, gifted with a marvelous sense of humor, and in every way a person eminently fitted to lead our sport.

Jacques was active as a competitor, judge, referee and official of the Federation Francaise des Sports de Glace, of which he was President for many years, and of the International Skating Union. He was French Champion in Singles in 1942 and in Pairs for 1946 to 1950. During these years, he also competed in Euro-

pean and World Championships and the Olympic Winter Games.

His service as an official of the International Skating Union began with his election to the Technical Committee for Figure Skating in 1955. He became Chairman of that committee in 1957. Beginning in 1959, he served as Vice-President, and succeeded to the Presidency upon the death of Ernest Labin in 1967. He was re-elected to the Presidency at every ISU Congress held since then.

He had been decorated by many countries. In France, he was a Chevalier of the Legion of Honor and an Officer of the National Order of Merit.

It will be difficult to find the like of Jacques Favart again.

—John R. Shoemaker

Ladies in Waiting

—Mary Ann Purpura

The competitive year following an Olympic competition is always an interesting one for it brings new faces to the forefront and, in a sense, reverses the process leading up to the Olympics—instead of a narrowing of the field down to an elite few, there is a broadening of the field to include new possibilities. Everyone takes a step back to look at the whole competitive picture.

The competitive picture in Senior Ladies should be particularly interesting this year, as there are several “ladies-in-waiting” for an opportunity to move up in the national standings and possibly claim a national title. After three years of being “always the bridesmaid,” Lisa-Marie Allen can look forward to a Nationals minus her nemesis, the now retired Linda Fratianne. Sandy Lenz, 1980 U.S. Ladies’ Bronze medalist, has become known for providing fans of amateur figure skating with the kind of personality-packed performances they previously got from Dorothy Hamill. After an outstanding first year in Senior Ladies, Elaine Zayak placed fourth in Nationals, and is hoping to better that this year with some spectacular triple jump combinations. Simone Grigorescu, who placed fifth in Nationals last year, is hoping that her dramatic, balletic style will secure for her a standing in the top three of the nation. As a first

year Senior Lady, Tiffany Chin’s senior record in Nationals remains to be written, however, the word from the West Coast is that Tiffany skates with a sophistication and feeling beyond her years, and could very well spoil the dreams of the more experienced Seniors.

Here then is a look at a few of our “ladies-in-waiting,” waiting for the 1981 Nationals in San Diego where their dreams will be decided.



Simone Grigorescu

A New Home New Hopes



—Karelei Tulenko

In 1981, the Women's U.S. Figure Skating Championship will be up for grabs and there are at least four skaters with the potential to take the title. Among them is eighteen-year-old Simone Grigorescu, a skater known for her utterly classical skating style.

Simone has competed in Nationals, in Senior Ladies, for the last two years. In 1979, she finished in seventh place. In 1980, she moved up to fifth place and missed out on going to the Olympic Games by just one point. In 1981, she hopes to make it to the top spots in the sport. Simone says, "The 1981 National competition will not be easy, but my goal is to make it to the U.S. World Team."

Although only two Senior Ladies will be on the U.S. World Team in 1981, Simone's goal is both realistic and feasible. She has the talent and the determination that go into the making of an American skating champion. She also has an unusual personal background that has taught her to be patient, to cope with difficult situations, and to dream seemingly impossible dreams.

Simone was born in Bucharest, the capital city of Rumania. She began to skate when she was seven-years-old on an outdoor artificial ice rink and before she was nine, she was taken into the Rumanian government's skating program. Simone explains how this program worked: "We lived at home; we skated only five months out of the year; we received group skating lessons which were paid for by the government; and we were given two pairs of skates each season free of charge. At the end of the season, the skates were to be returned to the government and they were then passed along to someone else."

Skating in Rumania was a second-class sport and Simone adds, "The instruction we received was terrible. The instructors were all self-taught and they had no idea what they were doing. One of my instructors was an ex-gymnast who took up skating at the age of twenty. By the time I was twelve, I was Junior National Champion; but the standards were very low and the title didn't mean a

thing." Also, by the time Simone was twelve, her parents had enough of the communist government of Rumania and were planning to defect. Simone, being so young, was not told of their plans.

Simone's father was an engineer. In the winter of 1972, he quit his job and became a vocalist with a band. Shortly thereafter, the band went off to Yugoslavia to play in a night club and Mr. Grigorescu went with it. Mrs. Grigorescu, who was a lawyer in Rumania, spent the next six months trying to get a passport for herself and for Simone, and a government permit to visit her husband in Yugoslavia. When it was granted, she and Simone left Rumania. Simone, who still did not know they were about to defect, says all they took with them when they left was one suitcase of clothing and one pair of government issue skates.

In Yugoslavia, the Grigorescus were reunited and together they hitch-hiked across the border into Austria. Simone recalls, "We waited for a long time on the roads to get a ride into Austria. I guess we must have looked like defectors because nobody would stop for us! Finally, a German tourist picked us up and drove us across. When we got to Vienna, my mother told me we were never going back home. At first, I did not believe her. Later, I felt very sad because I realized I would never see my grandparents or my friends again."

The Grigorescus spent three weeks in Vienna and then moved on to Cologne in West Germany. They tried to find work, to settle down and to make a life for themselves there, but they encountered many difficulties. In Cologne, Simone tried to keep up her skating, but was unable to do so. She found an indoor rink and an instructor willing to take her on, but the Grigorescus could not afford to pay for the ice time or the lessons. Simone says, "We stayed in Cologne for nine months, but we really wanted to go to America. I wanted to go to New York City; I knew all about that city from movies and going there, for me, was like an impossible dream."

In 1974, Simone's dream came true and the Grigorescus arrived in New York

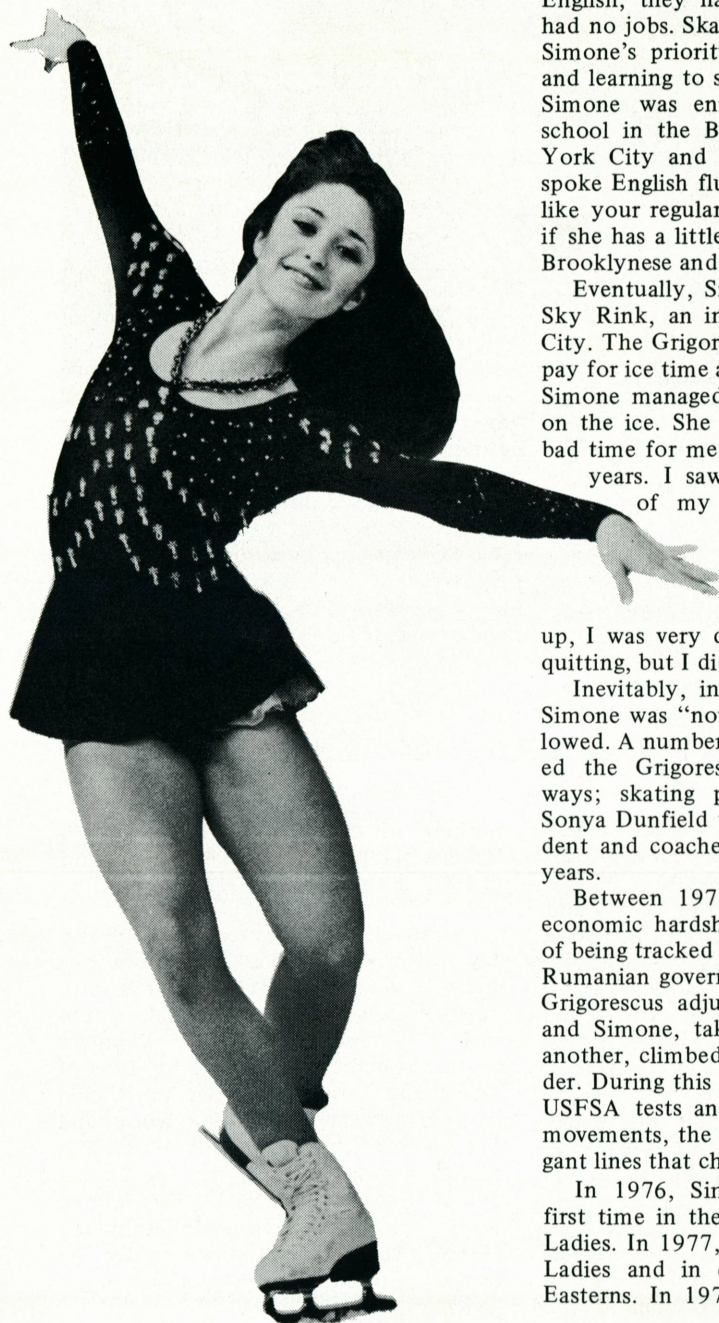

City. In the beginning, life in New York was very hard for them: they spoke no English, they had no money, and they had no jobs. Skating was the last thing on Simone's priority list, survival was first, and learning to speak English was crucial. Simone was enrolled in a public high school in the Brooklyn section of New York City and in less than six months spoke English fluently. Today she sounds like your regular American teenager and, if she has a little trace of an accent, it is Brooklynese and not Rumanian.

Eventually, Simone found her way to Sky Rink, an indoor rink in New York City. The Grigorescus were still unable to pay for ice time and lessons, nevertheless Simone managed occasionally to get out on the ice. She recalls, "This was a very bad time for me. I had not skated in two years. I saw what American skaters of my age were doing and I knew I was very far behind them. When I realized the work I had to do in order to catch up, I was very discouraged. I considered quitting, but I didn't."

Inevitably, in New York's Sky Rink, Simone was "noticed" and help soon followed. A number of local skaters supported the Grigorescus in many different ways; skating professionals, Peter and Sonya Dunfield took Simone on as a student and coached her for the next three years.

Between 1975 and 1978, in spite of economic hardship and the constant fear of being tracked down in New York by the Rumanian government and deported, the Grigorescus adjusted to life in America; and Simone, taking one slow step after another, climbed back up the skating ladder. During this time, she passed all eight USFSA tests and developed the flowing movements, the soft landings and the elegant lines that characterize her skating.

In 1976, Simone competed for the first time in the United States in Novice Ladies. In 1977, she moved up to Junior Ladies and in competition made it to Easterns. In 1978, she competed for the

Photo by: Irwin Steiner



first time in Senior Ladies' and in 1979, was first seen in this category on a National level. Looking back, Simone says, "I had a slow start in skating and a long interruption along the way. When I first came to America, I lost confidence in my ability to skate and it was hard work to build it back up. Now I know that if I have managed to come this far, I will make it the rest of the way to my goal."

In 1978, Simone and her parents pulled up stakes again and moved from New York to Denver, Colorado. For the last two years, Simone has been training there and her skating has matured and taken on a refined lyrical and expressive quality. But the milestones for the Grigorescus during this period had

nothing to do with skating: in 1979, Simone graduated from high school, and in 1980 all three became U.S. citizens.

Although the Grigorescus are probably over the biggest hurdles in their long journey from Rumania, life still is difficult for them. Simone's parents have jobs now, but extra money for Simone's skating is still hard to come by. Lots of talent and little cash is not an unusual combination in the skating world and Simone, in this respect, is not unique. But Simone's spunk and courage *are* unique and at the 1981 Nationals, where four or more equally talented and determined skaters will be competing fiercely for the Senior Ladies' title, these qualities might give her the winning edge.

Fourteen years ago, a six-year-old girl was fascinated by the challenge of a climbing rope hanging from the gym ceiling. She proceeded to climb it, discovering to her delight that it fulfilled her expectations, and consequently refused to obey her peers and teachers calling to her to come down.

Now, twenty-year-old Sandy Lenz refuses to "come down" from her skating ambitions, still striving to climb higher and higher on her rope of success. Most skaters entering their twenties and having skated in the Olympics might consider it time to retire from amateur skating to skate professionally, but not Sandy. As far as she's concerned, her work isn't over. She hasn't reached her peak. Now Sandy is training to prepare herself to "win" the Nationals and a medal from Worlds. "Psychologically she's very hungry—she's not at all satiated by her past accomplishments," her coach, Evy Scotvold, explains.

Her past accomplishments include placing ninth as an Olympic team member, third in National Senior Ladies, and first in the Midwestern Senior Ladies in 1980. She placed in the upper third in fifteen out of nineteen competitions since 1975.

When I asked her to list her accomplishments, she looked at me in disbelief and struggling with her memory, completed the task in fifteen minutes. "I didn't know I did so much!" she finally said with astonishment.

But she has done a lot, and she is competitive. Perplexing as it may be, she remains humble. "She doesn't think of herself as anything special," observes her coach. He attributes this to the stressed definition of a "good" skater as being the number one skater.

Her parents feel that her attitude is partly the result of their emphasis on leading a normal life. "It's a God-given talent that she has," Sandy's mother explains. "She's just developing what she's been given."

Prior to Nationals, Sandy experienced a dilemma of her identity as "Sandy the person" and "Sandy the skater". She was concerned that people saw her as a skater stereotype. Now, however, she has



**the
girl who
won't come
down**

—Vicki Kurzrock

Sandy Lenz



Photo by: Brad Burt

balanced the two and perhaps realizes the tenor of her individual talent. "I've worked hard to get the label 'Sandy the skater,' and I'm proud of it," Sandy declares.

The hardest obstacles she overcame to achieve this label were dealing with nerves and discipline.

"I was petrified. I used to get off the ice and [be physically sick] I was so nervous," Sandy recalls of her childhood with a twinge. The skater explains that she wasn't comfortable with competitions until the pressure and stress was relieved from her.

In fact, people said that they could sense something different about Sandy's presence at the Olympics. They told Sandy they hadn't seen a performance like hers since Janet Lynn's.

The comparison to Janet Lynn is a telling one for it was Janet who introduced Sandy to the elegant art of ice skating—at a family outing when Sandy was eight. Since then Sandy has professed to amazed, yet believing listeners, "I'm going to be in the 1980 Olympics."

The secret ingredient of Sandy's famed free style and short program is simply Sandy. She integrates her personality into her skating.

"For the last two years, I've really put a feeling in my skating and I'm becoming more widely known for that feeling. I want the audience to enjoy it as much as I'm enjoying it," relates the 5-foot-2-inch sandy blonde. As for her Olympic performance, "I was just doing my normal thing," Sandy said.

Sandy Lenz

And indeed her audience enjoys it too. One glance at her onlookers reveals their participation in her every movement. She skates with grace, poise and expertise while wearing an honest, almost perpetual smile.

Sandy is a perfectionist of her craft, and ideally self-disciplined, but her coach says that she tends to handle criticism defensively. When he criticizes her, she steps back onto the ice and tries, Sandy says, with a determined voice, "to prove him wrong." "She can't stand not to do things well," Scotvold retorts. She also takes a longer time to do things, needing time to "chew" on new ideas, he says.

"Discipline," Sandy defines, "is when nobody has to tell you to do it. It's just something you want to do, and you teach yourself to stick to it." Her father's concern that, "It's hard as a parent to teach them discipline, but also, to be *individually* disciplined," has been marvelously accomplished.

From her experiences with criticism, Sandy finds ample room in her heart to help the younger skaters. As a child herself, she remembers crying after practices and contemplating quitting. But her previous sacrifices prevented her from giving up.

Sandy also finds time away from her busy schedule to help her friends. "She's always willing to listen," her best friend says with admiration. Sandy feels that listening is a very important ingredient in friendships, because it helps people to think things through and solve problems on their own.

Aside from her serious side, Sandy's parents, boyfriend, girl friend and coach are in general agreement about Sandy's lighter side. "She's a character. She absolutely will not *not* have fun in life—anywhere and anytime," her coach insists. He adds with a hearty laugh, "And of course she picks some of the most inauspicious times to decide she's going to have some laughs."

Sandy is optimistic, yet doesn't ignore the unpleasant things of life. She prefers viewing life with a light-hearted attitude—but acknowledges that seriousness has a

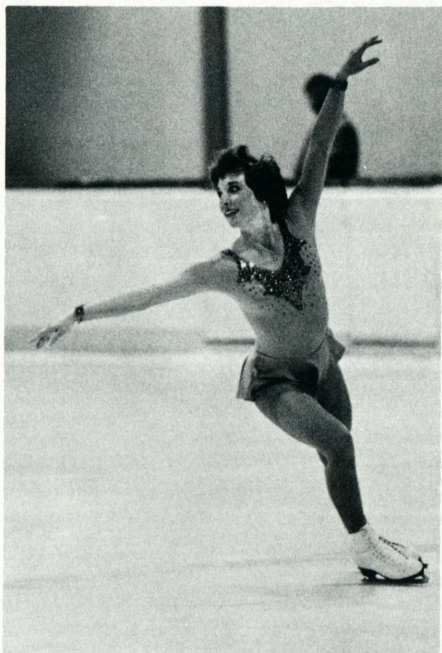

Photo by: Brad Burt

necessary place in life also: "We're here only for a short time, and we should make the most out of it."

Sandy's dream came true and her expectations were met at the 1980 Olympics. "I was free to go out and just have fun," she exclaims. It was quite a relief for her compared to the pressure from Nationals—which she had never before felt or imagined. Sandy speaks with enthusiasm of memorable experiences from the Olympic tour covering twelve cities and shows in eighteen days.

Having fulfilled her childhood dream, it now remains to be seen whether Sandy will realize her adult goal, a National title, at the 1981 U.S. Nationals in San Diego in February.

Elaine Zayak

Serious Senior

—Karelei Tulenko

In June 1979, *Skating* published an article on Elaine Zayak titled *Jubilant Junior*. The story ended with Elaine planning to take her Eighth Test, hoping to make it into Senior Ladies and having butterflies at the prospect of competing in this category. As everyone knows, Elaine passed her Eighth in September, made it into Senior Ladies, overcame the butterflies, and in competition had the Senior Superskates glancing over their shoulders.

The last ten months have been jam packed with excitement and plain old hard work for Elaine. During this time, she spent more than 1500 hours on the ice, participated in Regional, National, International and World Competitions, traveled more than 15,000 miles, and wore out three pairs of skates. What does she have to show for all of this? Recognition among skaters, a fan club, and a very good chance of becoming America's next Skating Queen.

Looking back, the fourteen-year-old from Paramus, New Jersey, says, "It's been a great year. All my dreams have come true except for one: I didn't go to the Olympics. But that was an unrealistic dream and maybe I'll make it next time." Her coach, Peter Burrows, adds, "In the last 2½ years, Elaine has gone from Novice to Senior Ladies. This is a phenomenal rise in skating. She competed for the first time in Senior Ladies this year against skaters who've been in the category for three or four years. In view of this, she has done extraordinarily well."

In the last 1½ years, Elaine has grown and developed both as a skater and as a person. The *Jubilant Junior* of 1979 became the *Serious Senior* of 1980. The transition was a smooth one that happened over many months. It began in the summer of 1979 when Elaine acquired a new look. Elaine explains, "Total

Image, they are beauty consultants in Atlanta, decided to use me as a guinea pig and to create a new look for me." As a result, Elaine lost her pony-tailed pixie look, got a short curly hairdo, make-up, and a more grown up image. Elaine adds, "If you are going to compete with Senior Ladies, you have to look like one."

Last fall, Elaine began intense training for the competitions. She got her triple loop jump, double Axel, triple toe and triple Salchow jumps. In November 1979, Elaine represented the United States in the Skate Prague Free Style Competition where she came in First Place. A week later, she competed in the Ennia Challenge Cup in Holland and finished in Second Place. These European Competitions were smooth skating for Elaine. They helped her work out the kinks in her programs and were fair training ground for the upcoming competitions in the United States.

Back home, Elaine made her debut in the Senior Ladies category at Easterns, held last December in Danvers, Massachusetts. After a year of competing in the relatively relaxed Junior category, she moved into the stress-filled Senior category with ease, assurance and flare. Burrows says, "Elaine thrives on competition. The tougher it is, the more she likes it. This showed up at Easterns." In the finals of this competition, she skated a spectacular four minute program to the music of Don Quixote and Mantovani which included six triple jumps, several of them in difficult combinations. This represented four more triples than any other skater performed at this competition. She swept Easterns like a new broom and finished in First Place.

Elaine left Easterns on a high note and entered Nationals, held last February in Atlanta, with hopes and expectations of finishing among the three top skaters. Although she skated the same spectacular



Photo by: Cynthia Kutchins

program she did at Easterns, and continued to pull triples like so many rabbits out of a hat, she finished Fourth. Elaine barely missed out on going to the Olympics and was dejected; but she says: "I found out at Nationals that in Senior Ladies to skate well is not enough. To jump well and do lots of triples is not enough. I did all that and didn't beat Sandy or Lisa-Marie or Linda. To win in Senior Ladies, you have to have style, you have to look mature and put together. Good presentation is very important. I didn't have it then; but I'm working on it." Burrows adds: "Elaine showed lack of maturity in her skating at Nationals. But she was only fourteen and competing against girls who were eighteen and nineteen. Her skating will mature, but it will take time. In a year or two it won't be a problem."

In spite of the fact that Elaine did not place among the three top skaters at Nationals, U.S. skating officials were so impressed by her performance that they decided to let her compete with the U.S. Team at Worlds. Elaine was thrilled and before going to Worlds she concentrated on improving the style and presentation of her programs. She worked with Burrows and other coaches, both on and off the ice, on such things as line, carriage, posture, positioning, extensions and arm movements. By the time Worlds came around, there was a marked improvement.

Worlds were held in Dortmund, West Germany, last March. Dick Button, commenting on Elaine's performance on National TV, said she is a very consistent skater who always comes through when it matters, described her triple jumps as magnificently performed and foresaw a wonderful career in skating ahead for her. As to the results of Worlds, Burrows says: "There were thirty-four contestants in Senior Ladies. The judges didn't know what to do with Elaine. They put her in twenty-second place after figures, in tenth after the short program, and in fourth after the long program. She finished eleventh overall."

For a fourteen-year-old in her first year of competition with Senior Ladies, Elaine had a sensational year. As a result, she has been the focus of increased media attention and coverage. Numerous articles have been written about her and she has appeared on National TV on several occasions. However, the sudden fame has not gone to Elaine's head and her family says she is still O.K.

But if worldwide press coverage hasn't spoiled Elaine, The Elaine Zayak Fan Club might. Elaine is clearly delighted to have her own fan club and says: "The club began after Worlds. My friend Joan Palladino, from Paramus, is the President. There are eleven or twelve members. They write to me and I write back. The club button says: 'E.Z. She'll make it EASY!'"

Like athletes competing seriously in most sports, Elaine's life can be accurately described as almost all work and no play. She skates six hours a day, six days a week, and lest she fall behind, four hours on Sundays. "I'm trying to get a consistent triple axel," she says. Burrows adds: "When she gets it, she'll be the first female to do a triple Axel. We're also working to improve figures and to get a consistent triple lutz."

Elaine is enrolled in the Ninth Grade at Paramus High, attends classes whenever she can and makes up for lost time with private tutoring. She has no time for hobbies or interests outside skating, she has few friends and virtually no social life.



Photo by: Diane Delozier

But, not all is gloom. In last year's Jubilant Junior story in this magazine, Elaine said the only thing she wanted to do in addition to becoming a great skater, was to learn to drive the car. This year's Serious Senior giggles and says: "Guess what? I can drive! Next year I'm getting a learner's permit." Next year, some experts on skating predict, Elaine may also be getting National and World Skating Titles.

NEW!



- Individual**
- Complete Freedom of Movement**
- Secure**
- Lightweight**
- Fits Most Sizes**

SKATETAPE is a specially designed vest containing a micro - recorder unit which allows a serious skater to practice repeatedly with individual competition music, supplementing Freestyle Patch sessions.

For further information or to order, send check or money order to:

SKATETAPE
P.O. box 853
Novato, CA 94947

\$130⁰⁰ ppd.
(Calif. res. add
6% sales tax)

(Circle No. 7 on reader service card)

1980-81 Rulebook is now available!

CONTAINS ALL THE NEW SKATING STANDARDS
AND BY LAW REVISIONS, PLUS MANY NEW AND
UPDATED RULES VITAL TO ALL INVOLVED IN
THE FINER POINTS OF AMATEUR ICE SKATING.

Contains:

- Current figure skating rules.
- Committees.
- Judges listings.
- Inter-Club Associations.
- USFSA Clubs, Officers
& Judges.

Only \$5⁵⁰*

* USFSA Member price \$ 4.95

USFSA Clubs can bulk order for \$ 4.70
(10 or more copies).

Colorado residents add 5% sales tax.

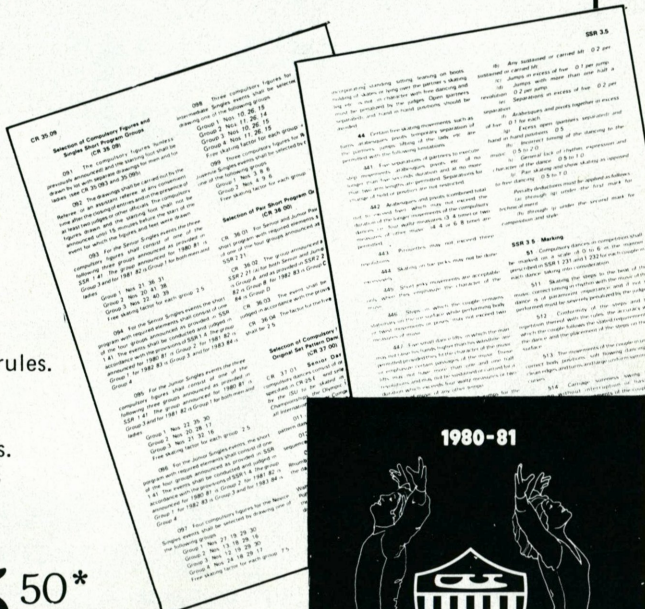

Send your order today to: **RULEBOOK**
USFSA
20 First Street
Colorado Springs, CO 80906



Tiffany Chin

*San Diego's
Good Luck
on the Ice*

—Gloria Williams

Seems like the nicest thing that could happen to a city, about to host the U.S. Figure Skating Championships for the first time, is to have the most extraordinary skater in its history emerge simultaneously.

That, you might say, is the good luck San Diego found in its fortune cookie!

When San Diego realizes a forty-year dream by hosting Nationals in February, a tiny Chinese-American bundle of talent named Tiffany Chin is likely to be a "local favorite" competitor. Not only is she the most extraordinary skater in her home town's history, she scored on the National scene as well last season.

And this month, at the Junior World Championships in London, Ontario, international skating will get its first look at this promising youngster who took the 1980 U.S. Nationals by surprise.

At barely twelve years of age and with only 4½ years on the ice, Tiffany qualified for Nationals for the first time last season as the youngest junior competitor since Linda Fratianne in 1973.

Then, in Atlanta, she matched Linda's 1973 accomplishment by placing second in the class against skaters all two to four years her senior.

To do it, Tiffany had to overcome a shaky seventh-place start, after a mild case of first-Nationals nerves caused her to put her foot down on one figure. She fought back with two stunning freestyle performances that had her name bouncing off the Omni walls. The fact that her short program held up for first place from first skating order pretty well tells the tale!

Knowledgeable observers tossed verbal bouquets ranging from "technically excellent" to "superb flow" and "marvelous musicality." While Tiffany may have been a surprise to the 1980 Nationals crowd, her exceptional talent had long been recognized in her home area.

The icy odyssey of this tiny China doll started out just for fun, as most skating stories do. The Chin family bought a couple pairs of skates for one dollar each at a garage sale, and Tiffany and her younger sister, Tammy, tried them out at a neighborhood rink. It didn't do a thing for Tammy, but Tiffany took up residence!

Within a few weeks her mother barely recognized her as the skater doing the expert back crossovers down the ice, and decided some lessons were in order. Needless to say, the one dollar skates didn't last very long.

Since she immediately displayed such precocious natural talent for the sport, the decision was made early on to let Tiffany go through tests as fast as she could, without worrying about winning titles on the way to the top. She soon emerged as an exceptionally well-balanced skater, about equally adept at both figures and freestyle—and there have been no plateaus in her progress. At one point, she passed the fourth through the seventh tests, both figures and freestyle, in a single year.

In 1979, Tiffany just missed advancing to the Pacific Coast sectionals as an eleven-year-old novice. Then, last season, the hurry-up strategy paid off with her surprise National debut in Atlanta.

The Oriental achievement ethic is unquestionably an integral factor in Tiffany's success. Outstanding accomplishment is the norm in her family. Her mother, Marjorie, who was raised in China, has a master's degree in library science from the University of Southern California and was once the youngest branch library manager in Los Angeles County. Edward Chin, Tiffany's father, has a PH D in mechanical engineering from the University of California at Berkeley, and is currently a staff engineer with General Atomic Company in San Diego.

Eleven-year-old sister, Tammy, found her medium not long after Tiffany discovered blade edges, and she is now as much of a prodigy on piano keys as her older sister is on ice. Completing the family is five-year-old Michael—and everyone can hardly wait to see what he gets into!

Tiffany returned from the 1980 Nationals to great acclaim in her home town. She appeared with the Olympic Tour in San Diego, Los Angeles and Oakland, the first San Diego skater ever honored with such an invitation. The night of the San Diego performance, she received a tremendous ovation from the audience and was honored by the Mayor's office for win-

Tiffany Chin

ning the highest National figure skating medal in San Diego's history.

Since then Tiffany has passed both parts of the USFSA Gold Test and collected her first senior titles in two summer competitions. One was the annual Southern California Interclub meet and the other was the all-freestyle Arctic Blades Invitational, in which she topped reigning Junior World Champion, Rosalynn Summers.

For the last 2½ years, Tiffany has been training with Linda Fratianne's coach, Frank Carroll, in Los Angeles. The arrangement involves considerable travel, but mother Marjorie sees to it that Tiffany makes good use of the travel time to keep up with her studies—a family "must."

Long-range goals for Tiffany are, of course, senior World and Olympic honors. But for the present, she is concentrating on collecting the ladies title at the Junior World Championships, where she will be the youngest member of the U.S. team and very possibly the youngest entry in the entire meet. She turned thirteen in October.

Then, next month, she will make her bid at the Pacific Coast sectionals to qualify as the youngest senior for Nationals in San Diego come February. Her fans will be watching anxiously.

Comparisons with Linda Fratianne have become routine for Tiffany, and many southern Californians remember that the year after Linda's National splash as a twelve-year-old junior she didn't make it to Nationals as a senior.

Tiffany feels sure the extra incentive of having Nationals in her home town will see her through!

Tiffany practices her "Russian" on the family's back yard trampoline for approval of Tammy and Michael.



Photo by: J.K. Williams

A Skating Collector's Dream

the Vilchek Collection

—*Mary-Lucile Ager*

Many people seriously involved with figure skating find themselves sooner or later with a collection of skating memorabilia. Some of them turn into avid antique figure skating collectors roaming the world looking for treasures of the past. Like all collectors, those hunting have different interests in what they collect. Some specialize only in one area such as books, old skates, paintings, pins and the like . . . others hunt for anything and everything to do with the sport.

High atop a hill overlooking the Pacific Ocean a stone's throw from San Diego, stands a charming home full of every conceivable object having to do with figure skating. It's occupants are Irene and Victor Vilchek of Del Mar, California. Destiny played a large part in their lives, beginning

in Europe before they were born. Their parents were childhood friends and Victor's father was a member of her parents' wedding party. Both families eventually moved to the United States where Victor and Irene met as children through skating.

Both Vilcheks are totally involved with the sport. They have given many years of dedicated service by serving on a variety of committees. They are figure skating judges who travel to judge competitions and test sessions whenever asked. Over his long years in skating, Victor has been a club president, officer and several times a board member. Together they competed in many dance competitions.

For anyone interested in skating, a visit to this home is a wonderful experience into figure skating history. Upon arrival,



Photo: Courtesy of Victor Vllcheh

you first see the handmade old-fashioned wooden skate on top of the mailbox. An antique sled over the doorway displays the house number. Inside, the priceless collection is not confined to corner shelves as most others are. It is beautifully displayed throughout the house . . . even in the laundry room. The house itself is full of all kinds of antiques. Irene also collects figurines, cherubs and foxes. He also collects china dogs and cars. The handsome antiques cabinets and tables they have acquired display their figure skating collection perfectly.

The collection contains many pictures, decorated eggs, old skates including a replica of bone blades first used in A.D. 156, a hat covered with valuable pins dating back to the 1936 Olympics, antique porcelain figurines of all kinds, a stamp collection made entirely of skating issues, metal and china plates, an extensive collection of books and magazines including a 1903 "Woman's Home Companion" with a skating cover, the first edition of "Skating" magazine printed in 1923 and much more.

The fine art works include an original Winslow Homer pen-and-ink drawing done in 1820, a wood lithograph by Brandenhoff, several Currier & Ives and one of their most prized possessions, a beautiful 300-year-old Flemish painting of an outdoor skating scene that still contains some of the original wood frame. Mr. Vilchek, an accomplished painter, has also done excellent oil paintings of Peggy Fleming and Janet Lynn. It takes more than one visit to properly see everything.

Prominently displayed, but firmly tied to the wall in case of an earthquake, are a pair of cobalt blue French Royal matching vases. One has a four-inch likeness of Madame Pompadour on it. The other has Louis XVI skating. These date back to 1752 and are the only ones in existence.

Victor Vilchek has over sixty pairs of antique skates that he has restored himself to perfect condition. There also are many small skating lanterns first used in 1873 for night skating. His "junk" drawer alone would be the envy of most collectors.

The Vilcheks have been collecting for almost thirty years and every year find valuable items to add to it. A recent addition is a painting from the Sonja Henie collection.

The Vilchek collection is a major part of their lives and their house a museum in itself. Victor says it's not impossible that it will one day become a part of the USFSA Hall of Fame and Museum in Colorado Springs. There generations of figure skating enthusiasts will be able to see the beautiful skating treasures one family has searched for and carefully preserved.

Some of the collection was entered in the hobby division of the 1979 Southern California Exposition and Fair. It not only won the blue ribbon but a plaque for outstanding exhibit. During the period that San Diego will be hosting the 1981 United States National Championships, another portion of it will be on display in the Broadway department store in San Diego's Fashion Valley in honor of the Nationals.



Even on one of Irene and Victor's unique collection of automobiles can be seen proof of their total involvement.

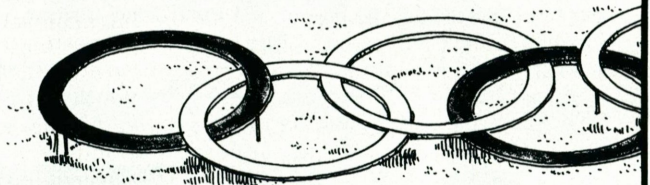
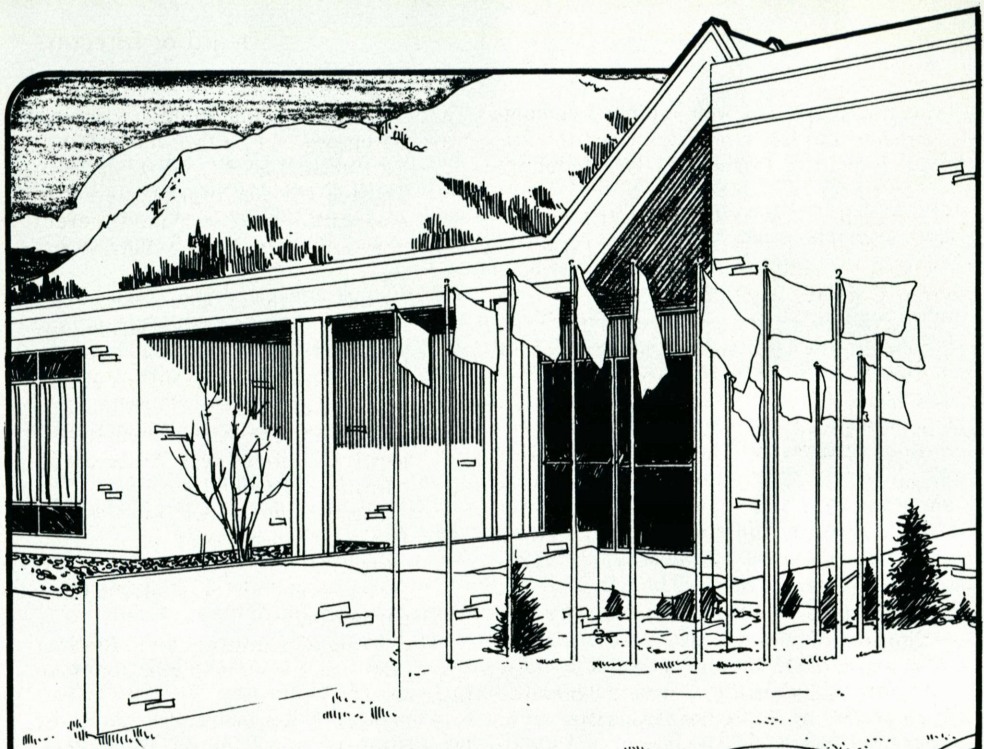

the 1980 Board of Directors Meeting - Report

—Ruth L. Jackson

When the members of the USFSA Board of Directors met at the Olympic Training Center in Colorado Springs on October 3-5, 1980, for the first time since the new Board was created by the revision in the USFSA By-Laws in May, 1980, they found a much improved facility. The dormitories had been renovated with new paint and colorful draperies and bedspreads in the rooms and the

meeting room was well-equipped as compared to the last two years when the former Executive Committee held meetings there under austere conditions.

President Oscar T. Iobst, Jr., opened the meeting by introducing new members who were not part of the former Executive Committee—Harold Hiltzik, George B. Ludlow, Jr., John R. Phelps, James E. Browning, Roger A. Glenn, Mrs. Janet Griffiths, Mrs. Carolyn Kruse, Mrs. Sherie Grimson and Stanley T. Urban, all elected members, Peter Carruthers, athlete-member and John A. W. Nicks, coach-member. Also introduced were Ronald T. Pfenning and Mrs. Eleanor Shultz who had served earlier on the former Executive Committee and had returned to the Board of Directors after an absence.

The first order of business was the adoption of a Memorial Resolution for Dr. Kenneth O. Turner, presented by Mrs. Betty Sonnhalter. Dr. Turner, a member of the USFSA Executive Committee from 1965 through 1971, died on July 17, 1980.

Subsequent to reports of the Sectional Vice Presidents, USFSA Auditors, John Bosse, Bob Snyder, and Roger Miller gave a presentation of the overall financial condition of the USFSA. They explained with a detailed use of graphics that the USFSA had a number of one-time expenditures accompanying the move of National Headquarters from Boston to Colorado Springs which had strained resources to some degree, but they anticipated projects which would bode well for the future.

Reinstated as amateurs in figure skating were George W. Bernard, Yarmouth, ME; Arlayne R. Donnan, Kentfield, CA; Joanne Fleming, Marquette, MI; Heidi A. Gulbranson, Prairie View, IL; Simone Marcotte, Plattsburgh, NY; Beth L. McAdams, San Diego, CA; and Helen K. Robinson, East Peoria, IL.

A proposed new scoring system adopted by the International Skating Union, which would provide for each part of a competition to be judged separately, factored and totaled for placement, was not adopted, but five recommendations of the Dance Committee were approved for submission to the Governing Council in May, 1981.

These rules would, if adopted:

—Remove the Silver Free Dance Test from CR 35.064 in order to upgrade the Senior Dance event in competition and to make the event correspond to Senior Singles and Pairs.

—Add the Silver Free Dance Test to CR 35.087 to upgrade the Junior Dance event in competition and correspond to Junior Singles and Pairs.

—Waive the solo requirement for the legally blind or deaf dance candidates for all dance tests.

—Change the name of Veterans Dance to Adult Dance.

—Provide for Adult Dance Tests, at all levels, to be skated with a partner only.

The Tests Committee will consider appropriate fees and emblems for these tests.

Following a report of the results of International Competitions held to date, International Committee Chairman, Howard G. Taylor exhibited samples of the ski parka, skating bag and wool sweater that were under consideration for the World Team. A London Fog coat with zippered liner and chevrons with the date will be provided for the World Team at the Worlds. A Polar Sports outfit, sweater, navy blazers, grey slacks and grey skirts are also under consideration for International Competitors.

The Team Trophy which the USFSA skaters won at the Coupe de Alpes Competition, held in Saint Gervais and Oberstdorf in August, was exhibited. Team Leader, William J. Brennan reported that the team of Vikki de Vries, Tom Dickson, Pairs Dana Graham and Paul Wylie and Dance Couple Susan Dymecki and Anthony Bardin, who were participating in their first International Competition, acquitted themselves well.

The Board of Directors were pleased to hear from Larry McCollum of Olympic House who noted that the boycott of the Olympic Games in Moscow had hurt fund-raising efforts, but the Olympic Committee was putting all that behind

Board of Directors

them and looking forward to the future. A fifty to fifty-five million dollar budget with development grants for National Governing Bodies over the next four years of fifteen million dollars is set as a goal. The USFSA planning allocation is estimated at \$96,000. Trials, team training, Olympic uniforms and expenses for two representatives to International Federation meetings, the Olympic Job Opportunities Program in cooperation with the Canteen Organization—all are anticipated to share in the Olympic funds, according to Dr. McCollum.

Noting that Colorado Springs is now the only training center left, Mr. McCollum said that some of the equipment originally at the closed Squaw Valley Center was now in Colorado Springs. He cited, in particular, a mobile Sports Medicine Van which could bring medical services to the athletes in the field.

In closing, Mr. McCollum made a plea for news items and photographs for "The Olympian" from which articles on "Olympian of the Year" will be chosen.

Although USFSA rules are reasonably in accord with Public Law 95-606 regarding National Governing Bodies, one other in regard to notice to a judge involved in removal, suspension, or demotion was deemed necessary. Consideration of the judge's explanation of the charges was approved in intent and such a rule will be under consideration in May, 1981.

Appointments were approved for the following judges:

GOLD FIGURE TEST

Dr. Elliott Cohen, Long Island FSC

Dr. Philippa M. Coughlin, Bridgeport SC

Mrs. Helen Oak, Long Island FSC

Mrs. Nancy Bizzano,
FSC of Minneapolis

Dr. Lester M. Cramer, Broadmoor SC

Monty Hoyt, Broadmoor SC

SENIOR COMPETITION

Mrs. Theresa Fischer, Park FSC

Monty Hoyt, Broadmoor SC

Mrs. Patricia J. Sodamin, Seattle SC

NATIONAL FIGURE

Mrs. Anne Gram Shean, Park FSC

Mrs. Gale Tanger, Wauwatosa FSC
GOLD DANCE TEST

Mrs. Ursula M. Gash, Suncoast FSC

Dr. Lester M. Cramer, Broadmoor SC

JUNIOR DANCE

Mrs. Joy Cunningham, Kent SC

Mrs. Patricia J. Sodamin, Seattle SC

The Board of Directors approved several judges' names to be recommended to the ISU for appointment and permission to take ISU exams: Mrs. Ardelle Sanderson for appointment as Honorary ISU Judge for Singles and Pairs; Mrs. Ida Tateoka, Mrs. Margaret Freepartner for appointment as World Dance Judge; Mrs. Ramona McIntyre to take the World Dance Test Judge's Exam in the spring; Mrs. Anne Gerli, Ray Alperth, Dr. Franklin Nelson and Mrs. Joan Gruber to take the International Judge's Exam; and Barlow Nelson, and Mrs. Eleanor Curtis and Mrs. Jean Robinson for appointment as International Judges.

A new category of membership was approved in principle for skaters taking Basic Tests. Details will be worked out by the Membership Committee and a recommendation may be submitted to the 1982 Governing Council for action.

The matter of "Showcase Competitions" was referred back to the Competitions Committee, from whence it came, for study. The ISU Rule which states that "Amateurs must not appear in any kind of exhibition, commercial motion pictures and television shows made either for direct theater distribution or production on television, in which non-amateurs, playing significant roles, constitute more than 20 percent of the total skating cast" was referred to the Sanctions Committee for study and recommendation. Also directed to the Sanctions Committee was the matter of investigation of ways in which funds can be diverted to the Memorial Fund from sanctioned events for non-skating related organizations.

The definitions for a half-revolution jump as "any jump of one half (180 degrees) revolution in the air", a single jump as "any jump of one or more, but less than

two revolutions", a double jump as "any jump of two or more, but less than three revolutions" and a triple jump as "any jump of three or more, but less than four revolutions" were approved. Also approved were Novice Figure Groups and inclusion of half-revolution jumps (split, half loop, mazurka, etc.) in the Juvenile Free Skating Test. These recommendations will be submitted to the May, 1981 Governing Council for action. A subcommittee of the Tests Committee has been appointed to study the whole structure of tests—records, forms, trial judges, etc.—and report in May, 1981.

Although domestic qualifying competitions in 1980-81 will not be affected, late changes in ISU regulations will apply to all International Competitions, effective December 1, 1980, according to Benjamin T. Wright, ISU Representative. In SSR 1.41, in all groups of the Senior Short Program "(f) spin combination with one change of foot and at least two changes of position (sit, camel, upright, or any variation thereof); in the Junior Short Program" (f) spin combination with one change of foot and at least one change of position (sit, camel, upright or any variation thereof) will be new. In 1, 2, 3, 4, (d), (e) - Spins (Senior and Junior): The next to last sentence will be revised to delete the following wording: "and a layback spin is not an upright spin." In 1, 2, 3, 4, (f), - spin combinations (Senior and Junior): will be revised to read: "must consist of one change of foot and at least two changes of position (Senior) one change of position (Junior) (sit, camel, upright or any variation thereof) with not less than five revolutions on each foot (a total of not less than ten). Any spin combination must include all three basic positions in the Senior Short Program and at least two in the Junior Short Program."

Announcement was made that Mr. John Shoemaker was named Honorary Vice President of the ISU. Mr. Shoemaker presented a resolution in honor of Jaques Favart, President of the ISU, who passed away on September 27, 1980, which resolution was approved by the Board of Directors.

William J. Brennan, Jr., Chairman of the Television and Commercial Sponsorship Committee, announced that the Association and ABC Sports, Inc., had reached an agreement covering the televising of National and Sectional Championships for the years 1981-1985 at a considerably larger payment to the USFSA than in the provisions of the previous contract. Under consideration is a first class International Competition, similar to Norton Skate, for 1981, with television coverage. Agreements with certain advertising agencies involving the brief appearance of amateur skaters on television commercials will produce income for the Memorial Fund.

The USFSA will participate in the National Sports Festival, July 23-29, 1981, at Syracuse, NY, by sending a team of twelve Ladies Singles, twelve Mens Singles, eight Pairs and eight Dance Couples. This will be a Junior Competition. Plans are also being laid to hold an International Competition the last two weeks in September, 1981, at Lake Placid, if sufficient local support is forthcoming.

In concluding remarks, President Iobst announced that F. Don Stoddard has resigned his position as USFSA Executive Director, effective October 30, 1980.

Members of the Board of Directors took a brief recess on Saturday afternoon to visit the beautiful Headquarters, Museum and Hall of Fame Building. They viewed the numerous acquisitions to the Museum, shopped for books, art works, jewelry, and skating gifts and visited with Staff Members to discuss ways to mutually serve the USFSA membership. They all purchased new USFSA Rulebooks recently off the press and then returned to the Olympic Training Center by bus for several more hours of deliberations.

Beautiful mountain views, clear sunny skies and the mountain air created an ideal setting for the well-conducted meeting where members expressed themselves freely in all discussions, but kept uppermost in their minds at all times the welfare of the skaters, the Clubs, and the Association. The outcome of the proceedings reflected that concern.

The
Inside Edge
Record Company
presents
New Ice Dance Records



**Orchestrated
Dance
Music**

sponsored
by

THE UNITED STATES FIGURE SKATING ASSOCIATION

LIMITED NUMBER AVAILABLE

Set 1A Preliminary & Bronze

DW: True Love
CT: Tango in D
SD: Love is a Simple Thing
FIT: Amapola
WIW: Melody of Love
TF: San Francisco

Set 1B Pre-Silver & Silver

14S: Yankee March Medley
EW: My Hero
FT: Me & My Gal
AW: Simplicious
T: La Cumparsita
RF: Object of My Affection

Set 1C Pre-Gold & Gold

K: Parade Au Village
BL: Camp Meeting Blues
PD: Real Madrid
3LW: Wine, Women & Song
VW: Cuckoo Waltz
WW: Come Dance With Me
QS: Cabaret
AT: Roman Guitars

GENERAL INFORMATION: All records are small hole 45 RPM discs with pre-attached strobe dials. Prices are \$20 for set 1A, \$20 for Set 1B and \$25 for set 1C. The complete series A, B, C sells for \$60. (New Jersey residents include 5% sales tax.)



ORDERING INFORMATION: Send complete name and address along with check or money order payable to:

THE INSIDE EDGE RECORD COMPANY, INC.
P.O. Box 544
Westfield, New Jersey 07091.

Please include \$2.00 postage and handling for each order.

LAURELS



SKATING congratulates the following skaters who have passed USFSA sanctioned tests in figures, pair and dance. Only completed dance tests, rather than the individual dances passed, are recorded below. Any errors should be reported to the USFSA, 20 First Street, Colorado Springs, CO 80906.

Gold Senior Freeskating

Hal Marron, Broadmoor SC
 James Mullen, Broadmoor SC
 Nanette Pasquini, Columbus FSC
 Amy Butterfield, Kent SC
 Elizabeth Names, Lakewood WC
 Tina Sjodin, FSC of Minneapolis
 Janice Kindrachuk, Skokie Valley SC
 Hollis Archinal, Philadelphia SC & HS
 Joy Hoepfl, Wauwatosa FSC
 Denise Devoe, Wissahickon SC
 Sally Odekirk, Professional
 Cheryl Hills, Professional

Gold Dance

Sandi Bonwell, Charleston FSC
 Janice Reinke, SC of Wilmington
 Patricia Bill, Yarmouth IC
 Cheryl Sett, Professional

Gold 8th Figures

Pamela Fates, The SC of Boston
 Victoria Devries, Broadmoor SC
 Craig J. Maurizi, Buffalo SC
 Kenneth Congemi, Cantiague FSC
 Kimberly Hollinger, Colorado SC
 Renee Biagi, El Camino ISC
 Brenda Vitters, FSC of Minneapolis
 Elizabeth Davis, FSC of Minneapolis
 Adam Leib, The SC of New York
 Hollis Archinal, Philadelphia SC & HS
 Kathryn A. Broom Hudson-Mohawk FSC
 Kathy Bailey, Rochester FSC
 Paul Tsigrikes, Rye FSC
 Lisa Ralston, SC of Sacramento
 Christine Vargha, Southern CT FSC
 Mary Mandel, St. Paul FSC
 Glenn Replogle, Troy SC
 Jeanne L. Diehl, Tulsa FSC
 Anne E. Rogers, Wissahickon SC
 Denise Devoe, Wissahickon SC
 Robin L. Mortensen, Yarmouth IC
 Diane Homa, Professional
 Pamela Dreyer, Denver FSC
 Sally Odekirk, Professional

ACADEMY FSC: 3—Kalinda Aaron, Sherry Barkman. 4—Beth Robins. Int FS—Kalinda Aaron. Nov FS—Beth Robins. Pre D—Margie Beals.

ACHILLES FSC: Pre—Dina Williams, Marie Matteo, Laurie Lessner, Debbie Machold, Cathleen Verno, Heidi Ritchey, Lisa Delano, Liz Coleman. 1—Anne Marie Parks, Lisa Cole, Dawnmarie Rispoli, Ann Marie Holck, Nicole Kelly, Kelly Clarke. 2—Kathleen Wolfe, Mary M. Lotano. 7—Jessica L. Potts. Pre FS—Brenda Hastings, Robert Hastings, Teddy Smith, Debbie Machold, Kerry Valyou, Kristen Frederick, Kate Frederick, Heidi Ritchey, Renee Famiano, Lisa Delano, Meg Ray, Renee E. Vogel, Liz Coleman. Juv FS—Elizabeth Ewing. Int FS—Kathleen Wolfe, Melissa A. Dominick, Kelly Clarke. Pre D—Amanda Daley, Kimberly Kershner, Sarah Smith, Amy Stake.

SC OF THE ADIRONDACKS: Pre—Maribeth McLane, Sue McDonnell, Donna Robinson, Teresa Jenkins, Amy Aronstramm. 1—Kelly Whitten, Michael Strack, Sharry Camp, Erin Harrell, Julia McLane, Jeanne Governale. 4—Julie Meyer, Julie Thornton. Pre FS—Michael Auger, Julie De Snyder, Bruce Boyden, Sue McDonnell, Donna Robinson, Amy Aronstramm, Erin Conway, Kelly Whitten, Amy Williams. Juv FS—Erin Harrell, Julia McLane, Shane Rowe, Teresa Landry, Donna Robinson. Int FS—Janene Meyer. Nov FS—Julie Meyer. Pre D—Lynn Foster, Maribeth McLane, Jeanne Governale. Pre-Silver—Susan Verville. Silver Free—Julie Meyer.

SC OF THE ALBANY ACADEMY: Pre—Christine Alexander. Pre FS—Joan Marie Lipscomb. Juv FS—Coleen Kane. Pre D—Joan Marie Lipscomb.

ALL YEAR FSC: Pre—Margaret Huck. 2—Sian Comora. 5—Sergio Ballongue, Jess Rick Rodzinka. Pre FS—Margaret Huck. Juv FS—Lisa Parisi. Int FS—Mie Enoki. Jr FS—Troy Goldstein. Pre D—Michelle Knotts, Mie Enoki. Bronze—Mie Enoki.

ALLEN PARK FSC: Pre—Julie Thornton, Kellie Templin. Pre FS—Julie Thornton, Kellie Templin.

ALPINE SC: Pre—Laura L. Lekowicz, Marne Vansise. Pre FS—Melissa Strauser, Marne Vansise. Juv FS—Shaula Ann Ferris. Int FS—Suzanne Johnson.

AMHERST SC: Pre—Kathryn E. Ruggles. 1—Shelia Shary. 3—Jennifer Pollock. Pre FS—Beverly L. Balsom, Kathryn E. Ruggles. Int FS—Jennifer Pollock. Pre-Silver—Jennifer Pollock. Silver—David M. Fedor.

SC OF AMHERST: Pre—Sara J. Lapen. 1—Melissa Evans, Christie Neville. 2—Ethan Starr. 3—Kimberly A. Morse. 4—Sharon Whittemore. Pre FS—Christina Berry. Juv FS—Ethan Starr, Johanna Fink, Nicole Mantovani, Patricia Gancorz. Int FS—Sharon Whittemore, Ann F. Miller, Linda June Mamulski. Pre D—Holly Kent, Christie Neville. Bronze—Patricia Gancorz.

ANCHORAGE FSC: Pre—Juanita A. Fiscus, Ronald E. Fiscus, Jr., Robin S. Glover, Laura Ford. 1—Maureen Redmond, Sheri L. Hardy. 2—Elizabeth Reinemer. 3—David Langman. Pre FS—Meghan Barstow, Kirsten Novak, Susi Worledge, Donna J. Sammons, Shelly R. Myers. Juv FS—Eric Ogren. Int FS—David Langman, Christina Moore. Pre D—Patricia Adams.

ANN ARBOR FSC: Pre—Carolyn Korvela, Yvonne Korvela. 3—William F. Hawkins. Pre FS—Carolyn Korvela, Yvonne Korvela. Juv FS—Monica Carter. Bronze—Deborah Kiley, Cheryl R. Coney.

ARCTIC BLADES FSC: Pre—Matthew Voce, Cathy Wiggins. 2—Kellie Murchison, Kelly Jean Collins, Krista Ruwaldt. 5—Diana Jones, Gregg Moon, Loreen Koshi. Pre FS—Matthew Voce, Cathy Wiggins. Juv FS—Kellie Murchison. Nov FS—Elaine Asanakis.

ARIZONA FSC: Pre—Kristine Magruder, Tod R. Nissle, Judy Ziggins. 1—Joanie Resnick, Kristine McFerren, Nadia Aityata. 2—Lisa Lea Plinski, Vicky Canner, Victoria A. Murphy, Nadia Aityata. 3—Lisa Feldman, Amy C. Gillette. 4—Amanda Agersea, Judy Webb. 7—Karla Earnhardt. Pre FS—Kristine Magruder, Julie Anne Fox, Kristine McFerren, Judy Ziggins, Nadia Aityata. Juv FS—Lisa Lea Plinski, Vicky Canner, Shawn McClintock, Victoria A. Murphy, Joanie Resnick, Nadia Aityata. Int FS—Judy Scholar. Nov FS—Judy Webb. Pre D—Tara Wells, Nadia Aityata. Silver—Judy Scholar. Silver Free—Thomas Rosenbaum, Kelli Haveman.

ARROWHEAD FSC: 5—Lesli Ann Calabro, John Davidson. Bronze—Michael Verlich.

ASPEN SC: Pre—Trista Larkov.

ATLANTA FSC: Pre—Natalie M. Farr, Kendrick H. Phillips, Jennifer L. Hyatt, Catherine Mathenson, Julie Akins. 1—Rebecca Rummil, Susan E. Dickson. 2—Colin Vander Veen. 3—Heather A. Dougherty. 4—Dawn Phelps, Jeb Rand, Janda Creech. 5—Cecilia McNamara. 6—Sherry A. Stephenson, Ann Fox, Amy E. Stevens. Pre FS—Natalie M. Farr, Kristin H. Novellas. Juv FS—Megan Ann Poole. Int FS—Dana Zahn. Jr FS—Sherry A. Stephenson. Pre D—Catherine Mathenson. Bronze—Susan E. Dickson. Pre-Silver—Buffy S. Crump, Colin Vander Veen.

ATLANTIC CITY FSC: Pre FS—Stephanie Gifford.

BABSON SC: Pre—Roanna London. 6—Scott Driscoll. Pre FS—Roanna London. Pre D—Wendy J. Walsh.

THE BALTIMORE FSC: Pre—Susan Reddy. 2—Tracy L. Sniadach. Pre D—Debbie L. Conklin. Pre-Silver—Wendolyn A. Jones.

BAY PATH FSC: 1—Robin Waldman. 3—Nancy Allan. Juv FS—Lisa J. Bartlett, Nancy Allan, Susan Geschickter.

BEAR MOUNTAIN FSC: 1—Missy K. Herman. 2—Allison Herman. Juv FS—Maryanne Cipolla, Allison Herman.

BELVEDERE FSC: Pre—Fumi Watanabe. 1—Vanessa M. Rafferty. Pre FS—Claude Gorham, Jr., Sharyl Williams, John C. Rafferty, Fumi Watanabe, Valerie Holt. Pre D—Harriet Nunn.

BIRMINGHAM FSC: Pre—Rouka J. Howell, Ellen H. Chen, George B. Moseley, Natalie A. Johnson, Kasey Bond, Julie L. Ponder. 1—Donna B. Pullen, Alice A. Chen, Tina D. Dees, Jennifer Farrar. 2—Jennifer Johnston, Priscilla Fowler, Estelle Lawrence. Pre FS—Carole Kent, Chanee R. McCollough. Juv FS—Charles L. Watkins, III, Donna B. Pullen, Lucia M. Kulhavy, Alice A. Chen, Tina D. Dees, Jennifer Farrar. Int FS—Leslie Stapp, Dawn Balch. Bronze—Charles L. Watkins, III, Priscilla Fowler, Donna B. Pullen, Norma E. McKittrick.

BLADE & EDGE FSC OF OMAHA: 3—Amy Cieslik. Int FS—Amy Cieslik. Pre-Silver—Holly Edson.

FSC OF BLOOMINGTON: 1—Dawn Victorson, Shireen Timm, Michelle Metzger. 2—B'Young Gi Hyatt, Marcia Carlson. 3—Lori Dawn Rutledge.

SC OF BOSTON: 3—Deborah Karchenes. 5—Wendy Salisbury. 7—Beth Ann Ottaviani, Ellen Jacobson. Nov FS—Wendy Salisbury, Suzanne Rheault.

BOWLING GREEN SC: 4—Amy Barber. Int FS—Nichole Oppliger.

BRAEMAR-CITY OF LAKES FSC: Pre—Bridget A. Underwood, Brandy Johnson, Katy Boedel, Christine Smith, Karen Gust, Leslie Moody, Hayley Harman, Lynne Peussug, Kirstin Blomberg, Alise Jarvis, Jeni Goggin. 1—Joanne De Moss, Edie Christian, Shannon Maas, Jennifer Nelson. 2—Julie Schoffman. 3—Nancy Wehage, Sarah Burman. 4—Michelle Olson. 5—Monica Christian. 6—Elizabeth Parrott, Debbie Lafond. 7—Tracey Klindworth, Lynette Larson, Jane Dekraay, Faith Levin. Pre FS—



CASS'S SPORTS CENTER

"We Cater to The Skater"

FULL LINE OF
EXCITING
ACCESSORIES



POLAR SPORT
TL CREATIONS
OBERHAMER
BEADS & TRIM
S.P. TERI
RIEDEL / INGA
WIFA / BAUER
C.C.M.

Skating Bags • Scribes & Cases • Skate Guards
Skating Miniatures & Figurines • Jewelry
Official Rule Book • Current Skating Books
Stationery • Gift Items.

*We design for champions, now we design for
you. Send 15¢ stamp for new catalog.*

WE CAN MAKE YOUR CLUB DRESS IN ANY DESIGN.

802 Cheyenne Blvd., Colorado Springs, CO 80906 / (303) 634-1418

(Circle No. 10 on reader service card)

Bridget A. Underwood, Brandy Johnson, Kathy Bloedel, Christine Smith, Karen Gust, Leslie Moody, Hayley Harman, Lynne Peussug, Kirstin Blomberg, Alise Jarvis, Jeni Goggin. Juv FS—Katie Wanninger, Diane De Moss, Michele Siderokos. Int FS—Ann Rooney, Shelley Lund, Jolene Johnson. Jr FS—Diana Edwards.

BREA CANYON FSC: Pre—Debra D. Neale. 1—Brenda Lee Yaw, Connie Romance. 2—Lynette Funaki, Kimberly Murphy. 3—Merry L. Wendel, Mary Oberjuerge. Pre FS—Debra D. Neale. Juv FS—Lynette Funaki, Kimberly Murphy.

BRIDGEPORT SC: Pre—Patricia J. Fredericks, George La Bounty, Heather Hastings. 2—Lauren Haskel, Christopher Bartlett. Juv FS—Hilary Gale. Nov FS—Elizabeth Wright. Pre D—Patricia J. Fredericks, George La Bounty.

BROADMOOR SC: Pre—Christina King, Sarag Thacker, Lisa Scuderi, Julianne Thompson, Jennifer Downing, Kathleen Shay, Melissa Getrost, Holly Robbins, Susan Van Camp, Julie Palsmeier. 1—Deborah S. Platz, Tammy L. Jones. 2—Shannon Goldsberry. 3—Jonny E. Keller, Nancy Row Barber. 5—Eddie Shipstad, Renee Sartuche. 7—Mary Lu Shipstad, Jim Cygan, Tashia Jones, Schonda N. Greene. Pre FS—Christina King, Jennifer Downing, Richard Chapman, Lisa Murphy, Karen Nagra, Julie Palsmeier. Juv FS—Zabrina Jones, Michelle Buttler, Karen Mulville, Sherilyn Schafer, Kristina Rhoades. Int FS—Kristin Lark, Tina Marie Valdez, Jonny E. Keller, Nancy Row Barber. Nov FS—Brett Drury, Cherie Jardine, Kim Murdock. Bronze—Gigi Siegert. Pre-Silver—Kerri Beth Davis. Bronze Pair—Tiffanie Wolter, Mike Beltch, Charles Goad, Margaret Goad.

BROOKLYN FSC OF OHIO: 1—Kelley Hopp. 3—Cynthia Rhyner, Garret Petrov. Int FS—Garret Petrov.
SC OF BRUNSWICK: Jr FS—Kimberlie Wheeland.

BUFFALO SC: Pre—Paul Clauss. 1—Hilary Olney, Jonathan Scibilia. 2—Nicole Brunner, Catherine Clauss. 3—Lisa Kreppel, Linda Rokicki. 4—Mary Burke, Deirdre Burke, Jill S. Lang, Luke H. Hohmann, Michelle Musialowski, Kezia Norton. 5—Susan Wynne. 6—Michael J. Murphy, Kathy Linneball. 7—James W. Disbrow. Pre FS—Fran Hamilton. Juv FS—Julie Macaluso, Michael Siepel, James W. Disbrow, Robyn Pratt, Lori Harrington. Int FS—Linda Rokicki. Nov FS—Carrie Richardson. Jr FS—Joseph Druar. Bronze—Marlene Hohmann, Hilary Olney. Pre-Silver—Julie Macaluso. Silver Free—Joseph Druar, Gina Marie Martucci. Pre-Gold—Kathy Linneball.

BURIEN SC: Pre—Jennifer Cina, Sarah Cina. Pre FS—Jennifer Cina, Sarah Cina. Pre D—John Jensen, Amy Madigan.

BURNSVILLE-MN VALLEY FSC: Pre—Siri Beiseker, Alane Lucht, Michelle Martin, Beth Nelson, Tanya Tetrault. 1—Stacy Vega, Kari Ann Dick, Marissa Olson, Michelle D. Lehnen. Pre FS—Kristin Iten, Alane Lucht, Michelle Martin, Beth Nelson, Tanya Tetrault, Kathryn Curielli, Laura Hanson.

CANTIAGUE FSC: 2—Aileen M. Schwartz, Helen De Quarto. 3—Jeanmaire Donahue. 7—John Stutts, Nancy Ann Ervolina. Pre D—Marie A. Pomilla Carter, Maryann Pomilla.

CAPITAL CITY FSC: 5—Bradley A. Williams.

CAROUSEL FSC: 2—Melissa Caspell. 3—Heather M. Hoffinger, Maria Pope. Juv FS—Cindy Eller. Pre D—Maria Pope. Bronze—Adrienne Green.

CARRIAGE FSC: 1—Karen Bublitz, Kara Rodewald.

CENTENNIAL SC: Pre—Teri Lynn Fay. 1—Martina Lademan, Elizabeth Pirc. 4—Alexandra McCready. Pre FS—Teri Lynn Fay. Int FS—Pam Hess. Nov FS—Alexandra McCready. Bronze—Julie McRae. Bronze Pair—Lisa Ann Montague.

CHALET FSC: Pre D—Deborah Wright.

CHAMPLAIN VALLEY SC: 2—Kim Liberty, Mary Tulip, Anne Marie McKenna. 5—Phoebe Frey. Pre FS—Kim Liberty, Basil Nicholson. Juv FS—Kim Liberty, Julie Hill. Int FS—Mary Tulip. Bronze—Anne Marie McKenna.

CHARTER OAK FSC: Pre D—Ronald P. Tramadeo.

CHICAGO FSC: Pre—Cynthia Havlik, Erin Jacobs, Julie Spinazze, Audra Anderson, Ellen Fierer, Lynn Fabel, Marni Gerstel, Tracie Robbins, Judith Schag, Shari Greenberger, Dawn Ries, Michelle Loch, Karoline Wojtalik, Leslie Richardson. 1—Lisa E. Klein, Stefanie Brown, Debbie Johnson, Lisa Kleeblatt, Dia Toussaint, Susan Grolig. 2—Tammy Gohde, Tracy Andrews, Sheryl Zimmerman, Dagny Fritsche, Jill Boba. 3—Judi Lendino, Malinda Weyrich, Donna Gebarowski, Maria Carvajal. 5—Monica Hoy. Pre FS—Kim Strain, Debbie Johnson, Cynthia Havlik, Erin Jacobs, Julie Spinazze, Audra Anderson, Helene Sever, Lynn Fabel, Marni Gerstel, Kim Metzner, Tracie Robbins, Judith Schag, Shari Greenberger, Dawn Ries, Michelle Loch, Karoline Wojtalik Leslie Richardson. Juv FS—Tracy Andrews, Minda Newman. Int FS—Jan Waggoner, Sandy Campanella, Malinda Weyrich, Michelle Nikodem, Kristi Smith, Maria Carvajal, Adreana Brad, Christie Edwards. Jr FS—Laura Kretekos. Pre D—Jan Waggoner, Jennifer Strong.

CHISHOLM SC: Pre FS—Diane Alberg, Tara Vanderport.

CHRISTMAS BROOK FSC: Pre—Coleen Murphy, Kelley Bator, Elizabeth Saulnier, Renee Lepel. 1—Christine Brooks, Brenda Briggs, Mary M. Bragdon. 2—Allison Kirby, 3—Maureen Maher. Pre FS—Elizabeth Saulnier. Juv FS—Christine Brooks, Brenda Maher. Int FS—Catherine Thompson, Susan Spofford, Allison Kirby. Pre—Silver—Brenda Briggs. Silver—Catherine Thompson.

CLEVELAND HEIGHTS SC: Bronze—Ellen B. Krist.

CLEVELAND SC: Pre D—Andrea Gullia.

CLINTON FSC: Pre—Barbara Ingersoll, Jerri Carpenter.

COLISEUM FSC: 4—Kristina L. Nebel. Nov FS—Candita Lanciano.

COLONIAL FSC: 3—Tracy O'Neil. 4—Amy Tolbert. Juv FS—Elaine Boyden. Int FS—Debra Huber, Tracy O'Neil. Nov FS—Amy Tolbert. Jr FS—Beth Ann Duxbury.

COLONIAL SC: Pre—Helen Jarvis, Christine Mendick, Dawn Sheva, Mary Jane Whiteley. 1—Jacquelyn Barr. 2—Patti Lee Thomas, Cheryl Schenk. Pre FS—Helen Jarvis, Kathy Coddair, Allison Cattani, Lynn Gioranette, Dawn Sheva, Jenna Toth, Mary Jane Whiteley. Int FS—Regan Lyn Tuerff. Pre D—Annette M. Kraft, Lyn C. Mooney, Lynn Gioranette, Paula Valvo.

COLORADO SC: 2—Shawnalyn Weigel, Lise Ann Faus, Michelle Robinson, Danielle Young. 3—Carrie Weber, Becky Burrell, Heidi O'Neill. 5—Amy Benson. 7—Sharon Komhyr. Juv FS—Shannon A. Chapman. Int FS—Heidi O'Neill. Nov FS—Kristin A. Goss, Sarah Beth House. Pre D—Danielle Young.

UNIVERSITY OF COLORADO: Pre—Yoly Parra, Jeanette Townley. 2—Douglas E. Cather. Pre D—Jackie Carbone, Margaret M. Kiernan, Clare M. Karat, Douglas E. Cather, Richard Strobel, Hillary Keyes, John Karat, Valory Strobel.

COLUMBIA FSC: 1—Suzanne A. Bergfalk, Kari Harstad.

COMET FSC: 1—Kim Faber. 3—Kathryn Wilkens. Int FS—Kathryn Wilkens. Bronze—Kathryn Wilkens.

COMMONWEALTH FSC: Pre—James Sears, Karen Cashman. Pre FS—James Sears.

CONEJO VALLEY FSC: Pre—Katerine Riley. 1—Janet Johnson. 3—Michele M. Keith. Pre FS—Theresa Stockemer, Katerine Riley. Int FS—Michele M. Keith.

CREVE COEUR FSC: 3—Angela Davis, Amy Sopuch. 4—Jocelyn M. Hallazgo. 6—Joan T. McKenna.

DALLAS FSC: Bronze Pair—Mary Ellen Diaz.

DANIEL BOONE ISC: Juv FS—Beth Anne Westerhoff.

SC AT DARTMOUTH: 1—Jacqueline Dyer. 6—Stephanie Yen. Juv FS—Jacqueline Dyer.

UNIVERSITY OF DELAWARE: Pre—Stacy Barnes. Pre FS—Nicole Piovoso, Stacy Barnes. Pre—Silver—Randi C. Berke.

DENALI IC: 4—Jodi Moore. Nov FS—Jodi Moore. Silver—Jodi Moore.

DENVER FSC: Pre—Marica Pook, Melissa McCarl. 1—Angie Samora. 2—Leslie Seick. 4—Jon Oldham, Jr. 6—Charles Zagar. Pre FS—Marica Pook, Melissa McCarl. Bronze—Victoria L. Vergato.

DEPERE FSC: Pre—Suzi Wright. 1—Nancie Nygard. 2—Kathleen R. Wallace. 3—Sandra L. Hout. Juv FS—Kristan M. Pokel. Int FS—Sandra L. Hout.

DESERT BLADES FSC: Silver—Pamela Watson.

DETROIT SC: Pre—Cynthia Prosser, Elizabeth Elliott, Justin M. Anderson, Elizabeth Snider, Keely L.

summer skate in the beautiful
COLORADO ROCKIES



announces its third annual
SUMMER SKATING SCHOOL

JUNE 22nd — AUGUST 14th

8 weeks of intensive training
plus many off-ice activities

comprehensive and diversified
skating program

professional inquiries invited

VAIL ICE ARENA
P.O. BOX 100
VAIL, COLORADO 81657

(Circle No. 11 on reader service card)

14Kt Skate Blade

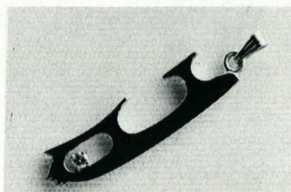

(actual size)

prices subject to gold fluctuation

Danah Cooper Jewelers

Hilton Plaza, Lake Placid, N.Y. 12946

(518) 523-2774

PLEASE SEND ME:

A/___14kt blade w/6pt. diamond
@ \$290.00

B/___14kt blade @ \$180.00

Check enclosed Am. Ex. Visa
 Master Charge

Card No. _____ Expires _____

Name _____

Address _____

Add \$3 per order for shipping
N.Y. residents add 7% sales tax.

(Circle No. 12 on reader service card)

Harris, Laura Scholler. 1—Pam Rebold, Jill Skrzycki, Verica Nikolic. 2—Lisa Zager. 3—Deveny Deck, Laurie S. Ezell. 5—Robin Norton. 6—Ron Holbrook. 7—Gary Dye. Pre FS—Kalyn Johnson, Wendy A. Zwemer, Melissa A. Campbell, Laura Scholler, Bridget Gibbs, Suzannah Whorf. Juv FS—Renee Besanson. Int FS—Renee Robitaille. Jr FS—Connie Kloecker. Pre D—Cynthia Prosser, Elizabeth Elliott, Kim Patterson. Bronze—Verica Nikolic. Bronze Pair—Susan Dungen, Jason Dungen.

DUPAGE FSC: Pre—Chantal M. Vestuto. 7—Annie Bodmer.

EASTLAND MALL ISC: Pre—Christie Hodgkins, Jeff Wartors, Pam Wartors, Alice Conboy, Carrie Costello. 1—Kimberly A. Romanowski, Susan E. Hampton, Meredith Williamson, Tina Costello. 4—Christina Kimball, Michelle Corder. Pre FS—Christie Hodgkins, Jeff Wartors, Pam Wartors, Alice Conboy, Carrie Costello. Juv FS—Katrina A. Thompson. Nov FS—Michelle Corder. Bronze Pair—Jeff Wartors, Pam Wartors.

EL CAMINO ISC: Pre—Andrea Roth. 2—Sharolyn Schneider. 3—Sharlene Mayda, Karma Lozada. 4—Lisa A. Schoeller. Pre FS—Andrea Roth. Juv FS—Sharolyn Schneider. Int FS—Karma Lozada.

ELMIRA FSC: 2—S. Alice Srastny.

EUCLID BLADE AND EDGE CL: 4—Susan Heltzel. Pre D—Cheryl Sue Keyes, Donna Repasy.

EVANSTON FSC: Pre—Tiffany Cole, Julie McCaffrey. 1—Christine Nelson, Beth Farber, Margaret A. Hickey, Kathryn Bates. Pre FS—Sandra L. Coneset. Juv FS—Betsy Dorner. Bronze—Rebecca Foose.

FAIRBANKS FSC: Pre—Mark Fink, Beth McConkey, Eric Piatt, Heike Schneider, Kari Wennen. Pre FS—Mark Fink, Beth McConkey, Eric Piatt, Heike Schneider, Kari Wennen. Pre D—Beth McConkey, Randy Rice, Randi M. Wagner.

FALMOUTH FSC: Pre—Jennifer L. Connors, Linda Eklund. 1—Lauren Corcoran, Wanda Sylvia. 2—Joanne Briana, Melissa Larrey. 4—Ann Marie Chicoine. 7—Kelly Smith. Pre FS—Jennifer L. Connors, Ann N. Novitsky, Kelly J. Rugg. Juv FS—Joanne Briana, Wanda Sylvia. Nov FS—Kelly Tierney, Kristin L. Tierney. Jr FS—Kelly Smith.

FLINT SC: 3—James L. Rotta. 4—Kelli Robinson.

FORESTWOOD FSC: Int FS—Patty Joo.

FORT WAYNE ISC: Pre—Danny Muench, Cheryl Keegan. 3—Debbie Callant, Judy Baldassari. Pre FS—Deanna Dauscher, Danny Muench, Mindi Martin, Diane Dager, Angie May. Jr FS—Beth Kaiman. Pre D—Laura Yerrick, Natalie Seybold, Wayne Seybold.

FRASER FSC: 1—Brandon Smith, Shanda Smith, Jacqueline Yarema. 2—Dawn D. Ford, Wendy L. Kuffer, Coleena Piccinini. 3—Loreen Thompson, Debra Lynn Hayden. 5—Stefany Fanelli. Jr FS—Deena Musser. Bronze—Jennifer Smith.

ISC OF FRESNO: Pre—Shelly M. Stafford. 3—Karl Schoettler, Krisiti Kirkbride, Shelly Motoyoshi. 5—Beth Rosenstein, Debra Anne Lemley. 6—Kevin Rosenstein. Pre FS—Shelly M. Stafford. Int FS—Karl Schoettler, Krisiti Kirkbride, Lisa Blakeley. Jr FS—Kevin Rosenstein. Bronze Pair—Karl Schoettler, Lori Mayne.

GALLERIA ISC: Pre—Donna Liversidge, Timothy J. Foland, Angie Neal, Zoe Nick. 1—Anne Marie Culotta. 2—Michelle Ho, Monique Ho. 5—Byron K. Darden. Pre FS—Donna Liversidge, Jaroslav Othal, Timothy J. Foland, Angie Neal, Zoe Nick. Juv FS—Michelle Ho, Monique Ho.

GARDEN CITY FSC: Pre—Jane Matthews, Robin L. Bostwick, Paula Chavka. 1—Dawn Hiscock, Lori Lee Spielman. 2—Gregory A. Campbell, Laura Clary, Barbara Piesiak. Pre FS—Kristin Donaldson. Int FS—Denise Matigian. Pre D—Meredith L. Hargrave.

GARDEN STATE SC: 1—Wendy Yodice, Kim Gallagher. Int FS—Jeannine McDonough.

GATEWAY/ST. LOUIS FSC: Pre—Alonzo Simmons. 4—Karolyn Flaherty. Silver—Karolyn Flaherty.

GENESEE FSC: Pre—Elizabeth Slutzky, Laura Carrillo. 1—Heather Ascroft. 3—Shari Heywood. Pre FS—Elizabeth Slutzky, Laura Carrillo. Int FS—Shari Heywood. Pre D—Helen Samolio. Silver—Bernadette Gerber.

GLACIER FALLS FSC: Pre—Lisa Ramirez, Gina Sue Rodgers, Catherine Zingali. 1—Phyllis Nemecek. 2—Tamara J. Brooks. 3—Lynn Wolfe. 5—Tajsha Thomas, Sandra Ramsbottom. Pre FS—Lisa Ramirez, Phyllis Nemecek, Gina Sue Rodgers, Catherine Zingali. Bronze—Ray Tuell.

GLACIER FSC: 1—Lisa Mac Iver. Pre FS—Jill Cahill, Lisa Mac Iver. Juv FS—Christine Cahill. Int FS—Michele Noe.

GLENWOOD FSC: Pre—Jennifer Brown, Gina Barker, Lisa Stallings. 1—Heather N. Reece, Ken Yamanouchi, Ann Marie Rosignolo, Amy Grimaldi. 3—Beverly R. Schilke. 5—Amy Aronson, Ashley Reece. 6—Paula Schoeneck, Cheryl Wyskup. Pre FS—Jennifer Brown, Gina Barker, Lisa Stallings. Juv FS—Carol A. Porges, Victoria M. Capodice. Int FS—Cruzita Garcia, Shannon Reece. Nov FS—Barri Tomei, Ashley Reece. Jr FS—Cara Lorey. Pre D—Ronald Sachtleben, Jr., Marybeth Krestan, Ann Marie Rosignolo, Lisa Stallings. Pre-Silver—Hayes A. O'Brien, Ken Mills.

GOLD & SILVER BLADES FSC: 1—Jeri Blatt. 2—Carolyn E. Adams.

GREAT LAKES FSC: 3—Tracey Kurcz. Juv FS—Holly Young.

GREAT FALL RIVER FSC: Pre—Carolyn A. Matula, Kathleen M. Souza. Pre FS—Susan J. Matula, Kathleen M. Souza.

GREAT MILWAUKEE FSC: Pre—Lisa Balistrieri, Renee Nonneman. 1—Catlin Bogue. 2—Kim Sanders, Tracy Sanders. Int FS—Renee Nonneman. Pre D—Leeman Loy Shick.

GREAT FALLS FSC: 3—Tenlee Mortensen, Thad Wocasek. Int FS—Thad Wocasek.

GREENFIELD AREA FSC: 1—Leah Latvis. 2—Tonia Hamel, Lisa Hamilton. Pre D—Kristina Streeter. Bronze—Tonia Hamel.

GREENWICH SC: Pre FS—Danielle Cote.

GROSSE POINTE SC: Silver—James Schilling.

HAMDEN FS ASSOC.: 1—Sharon Funderburk, Cynthia M. DeMatteis. 2—Kathy Doherty, Phyllis Appicelli. 3—Mark David Mitchell, Ellen Leonard. Int FS—Mark David Mitchell. Silver—Mark Server.

HARBOR FSC: Pre—Wendy Osburn, Stacy Ann Griswold, Brett Libenson, Laura Lopez. 1—Ruth Ann Early, Debby McDowell. 2—Stacy S. Aw, Lisa C. Kelley. 5—Jeffrey Smith, Erin M. Weatherford, Mary Guilbault. Pre FS—Wendy Osburn, Stacy Ann Griswold, Brett Libenson, Laura Lopez. Juv FS—Stacy S. Aw, Lisa C. Kelley.

SC OF HARTFORD: Pre—Stephen Novak, Christine Smith, Heather A. Harrington. Pre FS—Theresa Rizzo, John Novak, Susan Krupp, Karen Krupp. Juv FS—Diane Gallo. Jr FS—Alicia Eaton. Pre D—Priscilla Szablinski.

HAYDEN RECREATION CTR. FSC: 1—Jeannine Tanguay. 4—Allison Rosen. Pre FS—Sharon Rosenbaum. Juv FS—Diane Plemenos, Heidi Bertelli, Eddirland Enzmann, Nicholas Leary, Joanne Pomeroy. Int FS—Carolyn Francis. Nov FS—Alexander Enzmann, Daphid Lynch.

HERSHEY FSC: Pre—Kristen Prah, Shelley M. Ames, Tracey L. Krall, Kimberly McClune. 1—Lea B. Trefsgar. 2—Vickie M. Zuna. 4—Jody Hower. Juv FS—Geraldine Mapel. Nov FS—Jody Hower. Pre-Silver—Ruth Wilson.

HIAWATHA SC: 4—Jane Dale.

HIBBING FSC: Pre—Chris Radovich, Steve Nylund. 1—Kari Valley, Kathryn Anderson. 2—Susan Johnson, Lisa Venne, Christopher Ball, Jennifer Johnson, Holly Smith. 3—Lynn Holm, Susan Alfredson, Lori Lafave. 6—Debra Hamre. Pre FS—Kari Watson, Peggy Andrican, Steve Nylund, Lori Jarvi. Juv FS—Kathy Rudolph, Jennifer Sundvick, Stephanie Kearney, Kari Valley, Sherri Tomassini, Loni Langard. Int FS—Lynn Holm, Renee Drlaca, Athene Fotopoulos, Roberta Manney, Kiersten Krollman. Nov FS—Kelly Klinger. Pre D—Jeanine Anderson, Kelly Klinger, Loni Langard. Bronze—Jeanine Anderson, Kelly Klinger, Lori Lafave. Pre-Silver—Lori Hakola, Ginger Kangas.

HILLTOP ISC: Int FS—Monica R. Parasol.

HOLIDAY BLADES SC: 1—Deborah L. Beers, Paula Kornowicz. 2—Cindy Fretz, Janice Piskorowski. 3—Suzanne Laba. 4—Claudia Scheibler, Kimberly Johnson. Juv FS—Janice Piskorowski. Pre D—Susan Davis. Silver—Sheila Duggan.

Academics & Skating

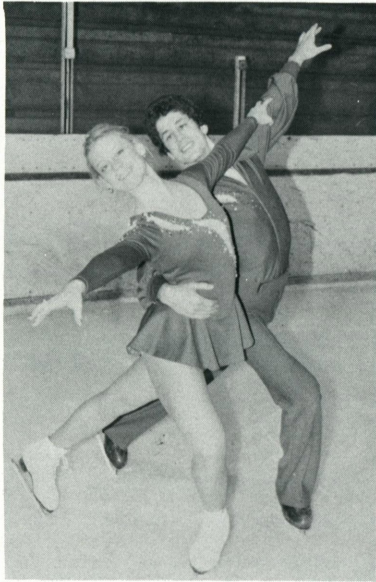

A unique boarding and day school, nationally recognized for preparation for college and performing arts, offers an opportunity for the talented & highly motivated skater to combine education with professional training. Up to three hours of ice plus a modern dance, ballet or gymnastic class available daily. 50-acre suburban campus 17 miles from Boston's cultural resources.

WALNUT HILL SCHOOL

FOR CATALOG CALL OR WRITE:

70 Highland Street
Natick, MA 01760
(617) 653-4312

Founded 1893

Grades 7-12

(Circle No. 13 on reader service card)

HOUSTON FSC: Pre—Sarah Brackney, Lisa Pappas, Diane Loranc. 1—Michelle L. Burman. 3—Tracy Ann Vincik, Lara J. Dunlap. Pre FS—Sarah Brackney, Richard A. Gilstrap, Jr., Lisa Pappas, Diane Loranc. Juv FS—Andrea M. Riener. Int FS—Lara J. Dunlap. Nov FS—Patrick L. Hancock, Bill Bell. Pre D—Laura Brunjes, Gregg H. Burman.

HUNTSVILLE FSC: Juv FS—Priscilla Rushing. Bronze—John Bowman.

ICELAND FSC: Pre D—Janna Blanter.

ICE WORLD FSC: 2—Janine Francella.

ILLINOIS VALLEY FSC: Pre—Suzanne Fisher. Pre FS—Heidi Stout, Suzanne Fisher.

ISC OF INDIANAPOLIS: Pre—Amber Smith.

INTERBORO FSC: 3—Amy E. Rosenblatt.

INTERMOUNTAIN FSC OF UTAH: 1—Alexis Megeath, Tamara Ann Schneider, Amy Jorgensen. 2—Cindy Burton, Jessica Berenson, Anna Oberle, Barbara Sartorius. Juv FS—Anna Oberle, Barbara Sartorius. Pre D—Cindy Burton.

JACKSONVILLE FSC: Pre—Julianne Outerson, Stacey Meharg, Lynn Girolamo, Abigail Malkewitz, Maria Malkewitz. 2—Jacquelyn Waina. 3—Staci Sears. Pre FS—Julianne Outerson, Lydia K. Rice, Stacey Meharg, Lynn Girolamo. Juv FS—Jacquelynn Waina. Int FS—Staci Sears. Pre D—Stephanie Chesson, Kristin Ebersol. Bronze—Ana Guerrero. Silver—Sheena Goldblatt.

JAMESTOWN SC: Bronze—Barbara K. Price.

KALAMAZOO FSC: Pre—Jill Barker. 1—Melissa Deridder. 2—Laurie Anderson, Lisa Smith, Mary Ellen Conway. 3—Carol Frank, Melissa Root. 5—Lisa Lennon. Pre D—Cary Wilson, Kristen Milani. Bronze—Laurie Anderson.

KANSAS CITY FSC: 2—Susan Sickels. 3—Kelly Huff, Stacey Sickels, Jennifer Beal. Pre FS—Amy Magerkurth. Juv FS—Susan Sickels. Int FS—Stacey Sickels, Stacey Williams.

KENAWAN SC: Pre—Ann O'Neill, Alissa Sue Van Slyke. 1—Susan Elia. 3—Christine Lewicki. Pre FS—Ann O'Neill, Alissa Sue Van Slyke. Int FS—Christine Lewicki. Nov FS—Christanne Randall. Bronze—Jennifer Walline. Silver—Nancy George.

KENT SC: Pre—Debra E. Koyle, Heather Richards, A. Lisa Head. 2—Kelly Mazzola, Heather Stewart. Pre FS—Debra E. Koyle. Juv FS—Heather Stewart. Int FS—Paula McGhee. Pre D—Kelly Mazzola, Christian Martin, Amy Litman, Kimberly Litman.

KEYSTONE FSC: Pre—Michele A. Hengst. 1—Beth A. Bollinger, Patricia Keegan. 2—Jennifer Satchwell,

Kelly R. Bowersox, Jennifer Hughes, Glen Booth. 3—Jane Capollupo. Pre FS—Christina Micholas, Carol Polson, Kerry Lynn Vogelsong. Int FS—Glen Booth. Nov FS—Jacqueline Davis. Pre D—Jennifer Hughes.

LA JOLLA FSC: Pre—Myron Mandell. 1—Diane Rogers, Gregory Levorchick, Christina Cole, Olivia Goldman, Shannon Sowers. 2—Diane Rogers. Pre FS—Diane Rogers. Pre D—Olivia Goldman.

LAKELAND FSC: Pre—Anne Marie Tangney. Silver—Rochelle Reaume.

LAKE MINNETONKA FSC: Pre—Karla Von Eschen, Darcy Davis, Sheryl Bearson, Heather Knapp. 1—Christine Tuite. 2—Wendy Ann Meck, Karen Meck, Niki Cunningham, Paula Smith. Pre FS—Heather Branson, Sheryl Bearson, Heather Knapp. Juv FS—Karen Meck. Nov FS—Leslie Brooks. Pre D—Dale Roberge, II, Dawn Roberge.

SC OF LAKE PLACID: Pre—Daniel Falcone, Michelle Gillespy. 4—Yvette LaBrake. 7—Brian Grant. Pre FS—Daniel Falcone, Michelle Gillespy. Pre D—Mark L. Swirsky. Bronze—Kelby Riley. Silver—Karen Cogan, Arthur Tripadush. Bronze Pair—Jeffrey Digregorio, Tracey Damigella.

LAKEWOOD WINTER CLUB: 2—Julie Ryndak, Anna V. Poulsen. 3—Michelle Nolan. 5—Carla Spangler. Pre FS—Tim Chilina. Nov FS—Karen Nolan.

LANSING SC: 2—Wendy Gelfius, Kathleen O'Malley. 4—Mary Jo Garmyn. 5—Deborah Leppek. Pre FS—Pipper Green, Kristin Szczotka, Buffi Toi Green. Juv FS—Ann Marie Anderson, Amy Zalman.

LAS VEGAS FSC: Pre—Melanie Spradlin, Melanie Radko, Artie Kramer. 1—Carey Davis. 4—Lynn Janssen. Pre FS—Melanie Spradlin, Melanie Radko, Artie Kramer.

LAUREL RIDGE SC: 1—Katie Rauh. 2—Peggy Deakin. Juv FS—Avenue McBride. Int FS—Debbie Ciripompa. Nov FS—Beth Ann Weingardt.

LAURELTON PINES SC: 3—Rebecca Convery. Juv FS—Lisa Kaplan. Int FS—Melanie Deutsch. Bronze—Ginny Fogarty.

LEOMINSTER FSC: Pre—Lisa Perron.

LILAC CITY FSC: 1—Gloria Teves.

LINCOLN CENTER FSC: 2—Jennifer Cashen.

LITTLE SUN VALLEY SC: Pre—Dena Grundstrom, Rebecca Hewes. 2—Kathy Ferguson, Jennifer L. Betit. Pre FS—Rebecca Hewes, Gina Petronella. Int FS—Thomas P. Riel. Pre-Gold—Christopher Macri.

LONG ISLAND FSC: Pre—Kim Trowse, Suzanne Silvis, Jennifer O'Rourke, Nancy McGuggart, Tara Gouz. 1—Claudia Mirante, Caryn Yap. 2—Lisa Mottola, Natalie Trezza. 3—Jeannine Reynolds, Linda Rose. 4—Kara Lynch. 5—Kristin Burkhardt. 6—Ruth Rosenthal. Pre FS—Suzanne Silvis, Jennifer O'Rourke, Jennifer Crecca, Tara Gouz, Barret Mulligan. Juv FS—Melanie Sokoloff, Lara Pelinsky. Int FS—Christine Targowski. Nov FS—Kara Lynch. Jr FS—Ammy Grossman. Bronze—Margaret Bodo. Pre-Silver—Margaret Bodo.

LOS ANGELES FSC: Pre—Eleanor Curtis, Christina Corey, Alison Pomerantz, Judy Estrada, Marian Mock. 1—Cori Woods, Jennifer A. Kautzky. 2—Julie Roessler, Heather Wofinbarger, Bridget A. Heuer, Diana Sue Stein. 3—Taylor Hawes, Christopher Borden, Sharon Kopman, Kyle McIntyre. 4—Michelle D. Lindsey. 5—Vicki Price. Pre FS—Eleanor Curtis, Christina Corey, Alison Pomerantz, Judy Estrada, Marian Mock. Juv FS—Ilene E. Locker, DeAnn Demers, Heather Wofinbarger. Int FS—Christopher Borden, Sharon Kopman, Eric Sassaman, Marianne Dick, Debbie Hove. Pre D—Carol Wood, Kristy Schoeman, Tara LaBarre, Paul Schoeman, Jofana Sonntag, Shelley B. Alexander, Sharon Wise, Dawn Fine, Sharlene J. Christy, Dana P. Class, Gigi Cutter, John Dlugolecki, Richard Lindsey, Michael Toft, Susan Washburn, Janet Weber. Bronze—Thomas R. Clark. Pre-Silver—D.J. Dyer. Silver—Heidi Berry.

FSC OF MADISON: Pre—Wendy Felton, Laura Macaulay. 2—Andrea Gambaro. Pre FS—Wendy Felton, Laura Macaulay. Pre D—Mary Jean Stewart. Pre-Gold—Carol Byrkit, Sheila Rich.

MANKATO FSC: 1—Ann Marie Daufenbach. 2—Brenda Racichel, Christina Radichel. Juv FS—Brenda Radichel, Christina Radichel, Ann Germundson. Int FS—Shelly Carroll, Shelly Torgerson.

MAPLEWOOD FSC: 1—Shannon Kratzke. 2—Yvette Chanco. Juv FS—Amy Anderson. Bronze—Cathy Ogren.

MARQUETTE FSC: Pre—Tara Wienczewski. 1—Marla Gerrish. Pre FS—Tara Wienczewski. Juv FS—Paula Bullock. Bronze—Carrie Bullock. Pre-Gold—Denise Cain.

MASS BAY SC: Pre—Christine Patten. 1—Gena Digregorio, Debra Lynn Patten. 2—Karen Tibbo. 3—Christine Jesso, Amy E. Porter. Pre FS—Christine Patten. Juv FS—Karen Tibbo. Int FS—Christine Jesso. Jr FS—Patricia E. Brannen.

MASSENA FSC: 3—Jody Pailer. Bronze—Joanne Hollander. Silver—Lorraine Yonally.

MEADVILLE FSC: Pre—Kim Kobel, Stacey Davis. 1—Lee Goans.

MESA VERDE FSC: 1—Kimberly Hamblin. 2—Alex Chang. Jr FS—Michelle G. Reed. Pre D—Karol Dangaran.

METROPOLITAN FSC: Pre—Carolyn Scharfman. 5—Rachel Schochet, Deborah Ruffano. 7—Gabrielle Passauer. Pre FS—Carolyn Scharfman. Nov FS—Rachel Schochet.

MIDLAND FSC: Pre—Mindy Lane, Karen Pappenfus, Michelle Gundrum, Julie Smith. 2—Lu Ann Henry. 7—Edward Hessenaur. Pre FS—Susan Whitaker, Katie Kemena, Charlesa Richardson, Julie Smith, Barbara Isenbarger. Juv FS—Andrea Roberts, Kathy MacDonald, Jeannine Holland. Int FS—Leslie Langworthy. Pre D—Mindy Lane. Pre-Silver—Lu Ann Henry.

MINERAL KING ISC: 2—Michele Frame.

MISSION VALLEY ISC: 5—Maria Montes, Cheri Lund. Juv FS—Theresa Pedro. Bronze—Paula Losinger.

SC OF MONTCLAIR: Pre—Jayne Turner.

BiSkates®

Best thing next to ice!



Figure BiSkate
with unique rotating
toepick.

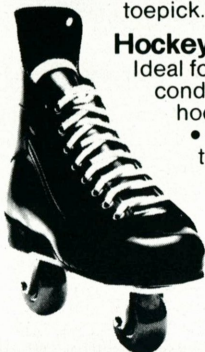

Hockey BiSkate
Ideal for off-ice
conditioning & roller
hockey.

- Sold direct from the factory.
- Free brochure & price list available.

THE ROLLER SKATE
YOU CAN BANK ON!



RLS PRODUCTS
P.O. Box 665 • Fort Jones, CA 96032
(916) 468-5532

(Circle No. 14 on reader service card)

ICE FOLLIES & HOLIDAY ON ICE

COMBINED SHOWS

WANTS BOYS AND GIRLS

Must have good,
strong skating
abilities. High
school graduate or
minimum 18 years
old.

Send Resume and Phone No. to:
Anne Schmidt
Ice Follies/Holiday on Ice
3201 New Mexico Avenue, NW
Washington, D.C. 20016

(Circle No. 15 on reader service card)

MONTEREY BAY FSC: Pre—Mollie Young. 2—Joelle Bakun. Pre FS—Mollie Young. Juv FS—Joelle Bakun, Tracey Fry De Bell.

MONTGOMERY FSC: Pre—Norma Zimmerman, Mitchell Bryant. 1—Frances Hutchinson. 2—Cassy J. Durham. Pre FS—Norma Zimmerman, John Zimmerman, Kelly Gilliland, Mitchell Bryant. Juv FS—Mitchell Bryant. Int FS—Frances Hutchinson.

NASSAU FSC: Int FS—Henry Handel, Michael Handel.

NEW HAVEN COLISEUM FSC: Juv FS—Betsy Angeletti. Pre-Silver—Michele Bellucci.

NEW HAVEN SC: 2—Virginia A. Clark. 4—Mary Delmonico. Juv FS—Virginia A. Clark. Int FS—Kristin Pumiglia. Jr FS—Beth Gates. Bronze—Kathy Arbour.

SC OF NEW YORK: 2—Dayna Madwatkins, E.J. Smith, Kyoko Ina. 5—Allison Oki, John Liotta. 7—Gioia G. Covo. Juv FS—Dayna Madwatkins, Kyoko Ina, Jr FS—Diana L. Emmet. Bronze—E.J. Smith.

NEWBRIDGE ROAD PARK FSC: Pre—Elissa Brill, Adrian Amendola, Elise Traugot, Renee Anderson, Susan Risolo, Renne Ruzicka. 1—Linda Myers. Pre FS—Elissa Brill, Adrian Amendola, Jennifer Mullins, Elise Traugot, Renee Anderson, Susan Risolo, Renne Ruzicka.

FSC OF NEW ORLEANS: Pre—Wendy E. Makofsky, Anne M. Temento, Maria Sevely. 1—Tara Riviere. 2—Lisa Marie Messina. 3—Wendy L. Boyd, John J. Kanicka. 5—Barbara Stafford. Pre FS—Angelique Melancon, Jane Butera, Wendy E. Makofsky, Anne M. Temento, Debbie Aileen Boylan, Merja Palkama. Juv FS—Jane Butera, Kelly Billingsly, Merja Palkama. Int FS—Lisa Marie Messina. Pre D—Tara Riviere, Angela Calamira. Bronze—Lisa Converse. Pre-Silver—Wendy L. Boyd. Bronze Pair—Julie Ann Seals.

NORDIC FSC: Pre—Kim Parker, Kristine Parker. 3—Sharie Green. Pre FS—Kim Parker, Kristine Parker. Int FS—Sharie Green.

NORTHCROSS FSC: Jr FS—Holly Louderback.

SC OF NORTHERN VIRGINIA: Pre—William W. Wanamaker, Jr., Sharon O'Boyle, Kimberly D. Palumbo, Erin Sasaki. 1—Kelly Willard, Abigail L. Crouch, Nancy Herrmann, Robbee Grossman, Mivaun K. Greschel, Connie Mezardash, Georgia Mezardash. 2—Rene M. McLaughlin, Darin M. Hosier, Elise Cohen. 4—Kathleen Bethards, Janet M. Bowers. 5—Cheryl Shriver, Holly K. Eisenhour, Natalie Staskiewicz, Heather V. Harris, Kari Joe King, Michele J. Moffat. Pre FS—Larry Munsey, Kimberly D. Palumbo, Erin Sasaki, Cathy Prisy. Juv FS—Kathryn J. Hurd. Nov FS—Margo McCaulley. Pre-Silver—

Kathryn J. Hurd.

NORTH JERSEY FSC: 5—Linda Franco. Juv FS—Scott Stewart. Bronze—Kara Hamill.

NORTH SHORE SC: Pre—Jennifer Holden. 1—Lee Hayman, Kim E Dejens. 2—Donna Balesteri, Victoria Marzioli. 3—Jo-Ann Fasano. 4—Martha Brennan. 5—Christine Johnston, Marcia Belliveau. 6—Julie Berube. Pre FS—Jennifer Holden. Juv FS—Susan Rosetti, Stephen Orne. Int FS—Jo-Ann Fasano. Nov FS—Lauren Smith. Jr FS—Cori S. Krane.

NORTH SUBURBAN FSC: Pre—Tanya Anandan, Julie Palermo. 1—Jennifer Juleff, Tracey Sonshine, Melissa Bacon, Elizabeth Bray, Gail Ann Dwire, Jennifer Whyard. 2—Leah M. Pierce, Mary Pagac, Jodi Balogh. 3—Corrine A. Haremski. 4—Pamela Werner. 7—Ann Marie Behen. Pre FS—Susan L. Taylor, Julie Palermo, Edward Mitchell. Juv FS—Patricia Behen, Leah M. Pierce, Dena Giancotti, Lisa Frazzini, Carmen Sarafa, Catherine Shubkin, Mary Pagac, Jodie Balogh. Int FS—Michele Bacon, Corrine A Haremski, Joy Herron. Pre D—Elizabeth Bray, Laurie Ham, Sandy Ham, Jennifer Whyard, Tanya Anandan, Robbyn Pioch. Bronze—Tracey Sonshine, Elizabeth Bray, Jeanne Leemon, Jodie Balogh. Silver—Mary Hagen.

NORTH YARMOUTH ACADEMY: 2—Margaret M. Macdiarmid.

OAK PARK FSC: 2—Melissa Motyka. 3—Jacqueline Conn. Juv FS—Melissa Motyka. Int FS—Jacqueline Conn. Bronze—Jacqueline Conn.

OLD CAPITOL FSC: Pre—Millicent McClure. Pre FS—Millicent McClure.

OLDE MONMOUTH SC: Pre—Becky Peterson. 3—Noreen Kelly. Pre FS—Becky Peterson. Juv FS—Aileen M. Kelly. Int FS—Noreen Kelly.

OLD YORK ROAD SC: Pre—Ellen Smiley, Shara Smiley. 2—Debbie Gray, Lori Gittleman. 5—Amy Rosinsky. Juv FS—Debbie Gray, Lori Gittleman. Pre D—Karen Buchsbaum, Lori Gittleman. Silver—Amy Kaji, Pamela Bossar. Pre-Gold—Eugene Kaji.

FSC OF OMAHA: Juv FS—Lori Lieberknecht.

OVERLAKE SC: Pre—Sally Adler, Deborah Condit. Pre FS—Sally Adler.

OWATONNA FSC: Pre—Meredith Hartle. Pre D—Amy C. Shearer.

OXFORD SC: Pre D—Lori Potter.

PALACE FSC: 1—John Baldwin, Jr. 2—Todd Brownley. Int FS—Todd Bromley. Bronze—Sara Anne McKeever. Bronze Pair—Todd Bromley.

PASADENA FSC: 1—Kara Franden, Cathy Dewey. Juv FS—Cathy Dewey.

PENGUIN FSC: Pre—Mary Hawk, Maja M. Hall. 1—Tracey Walker, John Pavis, Jennifer Stavros, Joe Groller. 3—Gwendel Talijan. 4—Michelle Ampoker. Pre FS—Kelly L. Specht, Michelle Rabel, Mary Hawk, Maja M. Hall. Juv FS—Cheri Soriano, Earl Warren, Heidi Renfer. Int FS—Gwendel Talijan. Nov FS—Michelle Ampoker. Pre D—Lori Jablonski. Bronze—Crislyn A. Pense, Susan Tuscher.

PHILADELPHIA SC & HS: 4—Stephanie Adler. 5—Ellen Gail Altschuler. Int FS—Stephanie Adler. Jr FS—Doris Papenfuss.

SC OF PHOENIX: Pre—Barbara A. Morgan, Tracie Hilton, Julie Holt, Joanna L. Klinger. 1—Bill Shanks, Dawn Adkins, Tina Gayle Morcomb, Amber Buntin. 5—Lisa Morelli. Pre FS—Tracie Hilton, Lisa Giles, Susannah Jones, Joanna L. Klinger. Juv FS—Vicki Ann Clevenger. Int FS—Michelle M. Lafond. Nov FS—Daniel Marrujo, Lisa Morelli. Silver—Laura Reiss.

PILGRIM SC: Nov FS—Catherine Clarke.

PITTSBURGH FSC: Pre—Ruth Cope. 1—Diane Litvinuk, Colleen Ridenour. Pre D—Lisa Scola.

PITTSFIELD FSC: 1—Jean Barker, Paula Pellerin, Susan Jakubowicz. 2—Joann Bromback. Juv FS—Maureen Matthews, Christine Pellerin, Laura Diana. Bronze—Erin E. O'Brien.

PLYMOUTH FSC: Pre—Julie Muchler, Sylvia Francis. 1—Michelle Hirschauer. 2—Michele Durkin. 3—Nachel Bohr, Jerod J. Swallow. 4—Michele Vinson. Juv FS—Gwen Cirbes. Int FS—Jill Matthews, Colleen Armstrong. Pre D—Noel Schmeck. Bronze—Paula Kowalczyk, Gwen Cirbes.

POLAR PALACE FSC: Pre—Catherine Hernandez. 7—Lisa Smith, Susan Fitzgerald. Pre FS—Catherine Hernandez.

PORTAGE LAKE FSC: Pre—Melissa Archambeau, Kathy Loukus, Brian Balog, Heidi Wehr, Suzanne Nies, Kathleen Doyle. Pre FS—Kristen Taylor, Nadine Predebon, Gloria Holappa, Denis Voelker, Julie Shiroda, Kathleen Doyle, Julie Halborg, Susan L. Johnson, Tracy Haines. Juv FS—Robbin Sintkowski, Tammy Sleeman. Int FS—Kim Moyle. Pre D—Kristen Taylor, Suzanne Nies, Nadine Predebon, Denis Voelker. Bronze—Melissa Albrecht, Kathy Balog, Lisa Remington. Pre-Silver—Kim Moyle.

PORT HURON FSC: 6—Kevin Poit. Bronze—Susan Sawaya. Pre-Silver—Nancy Pleger.

PORTLAND ISC: 5—Kirsten L. Bittle. Nov FS—Cynthia L. Brown, Kim Abbott. Pre-Silver—Richard L. Brown, Cynthia L. Brown.

PORTLAND SC OF MAINE: Pre D—Pamela J. Reinsborough. Silver—John Hatcher.

POTSDAM FSC: Pre FS—Krissanne Lewis. Pre D—Alison Kirchgasser.

PRINCETON SC: Pre FS—Jacqueline Fenenic.

PROVIDENCE FSC: 3—Judith Ann Rendine.

PUEBLO FSC: Pre—Paula Randolph. 1—Amy Peterson. 3—Karen Kilstofte. Pre FS—Paula Randolph. Int FS—Karen Kilstofte, Jani Friedman.

QUAKER CITY FSC: 2—Kimberly Redilla. Juv FS—Kimberly Redilla. Pre D—Carol A. Pilling.

QUEEN CITY FSC: Pre FS—Michelle Merkhofer. Juv FS—Mellisa Auburn. Nov FS—Jennifer Astore. Pre-Gold—Kristan Lowery.

SC OF RADNOR: Pre—Merry Siegel, Andrea Catoia, Joanne Hilferty, Marlena E. Buckley, Charlotte

HERE'S A GREAT Gift IDEA!!



ONLY \$8

includes
processing &
mailing
charges.

Send this Season's Skating
magazine to a friend
or loved one. . . .

Gift Certificate
skating
MAGAZINE
to

Gift subscription for 10 issues of Skating Magazine.
Compliments of _____

This attractive Gift Certificate will be mailed to the person(s) you wish with your compliments.

Your return request will allow us to immediately enter the subscription, and the first issue of the season — October, will be on its way.

A Great Gift Idea!!!

Simply fill out the gift certificate request card facing page 16 and drop it in the mail.

Don't delay! The sooner we receive your request, the sooner we can enter your gift subscription.

DeMoss, Kara Flynn, Patty Pellissier, Leigh Berman. 1—Jan Waldauer, Patricia A. Collins, Jane Wick. 2—Elizabeth Thorne. 3—Jacqueline Paytas. Pre FS—Merry Siegel, Ladan Ahdieh, Linda Weinberg, Michele Verdi, Joanne Hilferty, Marlana E. Buckley, Kara Flynn, Patty Pellissier. Juv FS—Cathy Lindsey. Int FS—Jacqueline Paytas. Pre D—Jane Wick.

RAMAPO FSC: Pre—June Fasano. 1—Heather Glew, Vicky Sackser. Pre FS—June Fasano. Juv FS—Tracy Lynn Martin, Robin Zeig.

RICHFIELD FSC: 1—Lisa Horn. 3—Joy Young. Pre FS—Renee Miller.

FSC OF RIVERDALE: Juv FS—Erin Leo. Int FS—Robin Zolotrow.

ROCHESTER INST. OF TECH.: Pre FS—Sarah Frost. Pre D—Karen Carpenter.

ROCHESTER FSC: Pre—Debbie Long, Ann Barsness, Lisa Noller, Holly Weaver, Erin Sedgwick. 1—Mike Stanger, Cindy House, Beth Klukow, Kelly Keilen. 2—Erin Lavelle, Sharyn Steele. 4—Jane Aswegan. 5—Cindy McKay. Pre FS—Erin Sedgwick, Vicki Brummond, Allison Suhler. Juv FS—Erin Lavelle, Sharyn Steele, Beth Klukow, Kelly Keilen. Int FS—Amber Rue. Silver Free—Marcia Hagen.

FSC OF ROCKFORD: 1—Diana C. Goolsbey. Pre D—Lori Snyder. Silver Free—Julie Ann Michalowski.

ROCKY MOUNTAIN FSC: 2—Angela Carazo, Andrea La Russo, Tracey Tucker.

ROSEVILLE FSC: 3—Cassi Philippi, Andrea Steinberg. 4—Sara Hallquist. 5—Lesley Farr. Pre FS—Stephanie Hillstrom. Int FS—Lisa Myaya, Andrea Steinberg. Nov FS—Chelly Keller, Sara Hallquist.

RYE FSC: Pre—Kaho Koinuma. 1—Raymi Taylor. 3—Iris Drey. 4—Irene Hahn. Juv FS—Christine Campbell. Int FS—Pauline Derosa. Nov FS—Karen Gail Zasky. Jr FS—James Yorke.

SC OF SACRAMENTO: Pre—Aleisa McGowan, Jackie Soto, Allen Neil Hart, Lara Fraser. 1—Kevin Campbell, Kimberly Wassenberg. 2—Magda Ayoub. 3—Samantha Purdy. Pre FS—Aleisa McGowan, Jackie Soto, Allen Neil Hart, Sonny Ellison, Lara Fraser. Juv FS—Magda Ayoub. Int FS—Debb Mart, Samantha Purdy.

SAGUARO VISTA FS: Juv FS—Lisa Firestone.

SALT CITY FIGURE SKATERS: Juv FS—Jason Mashie. Int FS—Jason Mashie. Bronze Pair—Jason Mashie.

SAN DIEGO FSC: 7—Sheri Jo Hanford. Nov FS—Erika Reynolds.

SC OF SAN FRANCISCO: Pre—Stanya Kahn. 1—Robin Vielmader, Alberto M. Rulloda. 3—Nanette Osoro. 7—Cathryn Young. Pre FS—Camellia Ngo-Ngoc, Stanya Kahn. Int FS—Nanette Osoro.

SANGAMON VALLEY FSC: Pre—Yvonne Lindsey, Susan M. Moreski. 2—Andrea Larusso. Pre FS—Yvonne Lindsey, Susan M. Moreski.

SANTA BARBARA FSC: Pre—Tracy Harrison, Leann Arnold, Frank E. Anderson, Maria De La Vega. 1—Tami Paulazzo. 2—Sally McLean. 3—Kristin Libera, Marla Schipper, Dody Benko. 4—Ava Eriksen. 5—Tanya D. Burke. 7—Jill Bath. Pre FS—Tracy Harrison, Leann Arnold, Frank E. Anderson, Maria De La Vega. Juv FS—Leanne Mezey, Sally McLean. Int FS—Kristin Libera, Michelle Ashcraft, Marla Schipper, Dody Benko. Nov FS—Ava Eriksen, Tanya D. Burke.

SANTA MONICA FSC: Pre—Lizabeth A. Fogel, Shannon Valnes, Bonnie Basaric, Julie Gidlow, Elizabeth Chase, Lorene Tanimura. 1—Yasmine Mustaklim, Stacey Jovett. 2—Stefanie C. Schmid. 3—Nadine Starr, Christina Lanon, Michelle R. Hawley. 5—Kristen Smith. 7—Bobbi Brown. Pre FS—Lizabeth A. Fogel, Shannon Valnes, Bonnie Basaric, Julie Gidlow, Elizabeth Chase, Lorene Tanimura. Juv FS—Stefanie C. Schmid. Int FS—Nadine Starr, A. Sultana Muhammad, Christina Lanon, Michelle R. Hawley.

SEATTLE SC: Pre—Jennifer Passage. 1—Heather McLaughlin, Lisa Passage, Julie Field, Kathleen Baker. 3—Kirsten Lind, Marybeth Baum, Teresa Walker. 5—Steve Gerard. Int FS—Kathi R. Kincaid, Teresa Walker. Bronze—Marybeth Baum. Pre-Silver—Luanne Didzun. Silver—Lisa M. Satre, Michele Powell.

SHAKER FSC: Bronze—Kelly Bowen.

FSC AT SHENANDOAH: 2—Christy Williford, Ji-Seop Yoon. 3—Tracy Flood. Pre FS—Angela Bratcher, Wade Duke, Barbara Chapmann, Carrie Ferguson, Patrick Roberson, Sandi Schaad. Pre D—September Wassenberg, Patty Breed, Tracy Flood, Christy Williford.

SIERRA NEVADA FSC: Pre—Gretchen Manske, Sara K. Shields, Angela Bahan, Tammy Massaro. 1—Jamie L. Gibson, Tanya Fageton, Traci Moccerro. Pre FS—Gretchen Manske, Sara K. Shields, Christie Clark, Angela Bahan, Tammy Massaro. Pre D—Pat Hardy Lewis, Tanya Fageton, Pamela Arlitz, Shannon Maclellan, Joan Admirand.

SILVER BLADES FSC OF GREATER KANSAS CITY: 3—Lynda Roth. 7—Frederick Roth.

SILVER BLADES SC: 2—Diane Winkelmann.

SILVER EDGE FSC: Pre—Lianne Hatcher, Ian Loyd, Elliot Chung, Menee Soliz. 1—Marla Vance, Janelle Vance. Pre FS—Lianne Hatcher, Ian Loyd, Elliot Chung, Menee Soliz. Juv FS—Suzy Smith. Pre D—Elaine Ettman.

SKANATELES FSC: 1—Lisa D'Agostino. Pre FS—Susan K. Weaver. Pre D—Tracey L. Weaver.

SKOKIE VALLEY SC: Pre—Sharon Ohr, Joanna Manos, Cynthia Ludlow, Tanya Gross, Laura M. Gordon, Nancy Oguss, Melina Maniatis, Laurie Wozny, Lori Strull. 1—Deborah Angel, Becka Schnepfer, Anastasia Wehrenberg. 2—Bettyann Rossa. 3—Marybeth Carlson, Jeffrey Whelan. 5—Debbie Garrity, Scarlett Aufman. Pre FS—Deborah Angel, Sharon Ohr, Karen Jaeger, Tom Jaeger, Joanna Manos, Cynthia Ludlow, Tanya Gross, Laura M. Gordon, Nancy Oguss, Melina Maniatis, Laurie Wozny, Lori Strull. Juv FS—Jeane Ecmovich, Katherine Hackbarth, Michelle Jackson, Louann Berke. Int FS—Maria Zarko, Lisa Ebenhoeh, Joy F. Geras, Susan Hamilton, Marybeth Carson, Jeffrey Whelan.



Introducing . . .

Figures coordinated Boot Bag and matching Scribe Case. Puncture resistant cordura nylon. Sand, red, blue and black.

Boot Bag \$36.65 Scribe Case \$23.30

Plus \$2. shipping & handling. Calif. residents add 6% sales tax.

Dealer inquiries welcome

**P.O. Box 5251
Berkeley, Ca. 94705**



(Circle No. 16 on reader service card)



SPECIAL CHRISTMAS OFFER
\$16.95
Offer expires 1/15/81

PADDED SKATER-AID

Krash Pad

LIGHT and trim looking cover for hips and seat. Protects bruises, reduces fear. Thousands are in use now! Most users are competitive skaters. Ideal for learning double and triple jumps. Firm, foam cushioning covered with navy blue, maroon, green, black, brown. All sizes just ~~\$19.95~~



EASY to put on or take off on the skating surface in seconds. Use only when needed.

Clip out, fill in and mail

KRAsh PAD by JAN-PRO 

P O Box 5154 San Diego, Ca 92105

Enclose check for \$16.95 ppd. (California residents add 6% sales tax.) Measurement around largest part of seat with skating attire on _____ Color _____

NAME _____

ADDRESS _____

CITY _____ STATE _____ ZIP _____

(Circle No. 17 on reader service card)

- Nov FS—Marge Minor, Lisa Vitikainen. Jr FS—Sharon A. Carz. Pre D—Susan Hamilton.
- SMITHFIELD FSC:** Pre—Kerrie Calabro, Laura Esposito, Jesse Earl Marsh, Stephanie Taylor. 1—Stacey Ihnat. 2—Suzanne Mesoletta. 3—Allison Grant. 4—Kerri Bell. Pre FS—Colleen MacDonald, Laura Esposito, Jesse Earl Marsh, Stephanie Taylor. Bronze Pair—Melissa J. Stockwell, Michael Olsen.
- SOUTHERN CT FSC:** 2—Lisa Billings. 3—Jennifer Wayne, Maureen O'Keefe. 4—Robin Harland. Pre FS—Trisha A. Matthews. Juv FS—Kelly O. Bara.
- SOUTH BAY FSC:** Pre—Christin Flynn, Dara Crowe, Wendy Brooks. 1—Carol Learoyd, Robyn Westfall, Shelly M. Graham. 2—Marlo Sipple. 5—Irene La Riva. Pre FS—Christin Flynn, Dara Crowe, Wendy Brooks. Juv FS—Marlo Sipple.
- SOUTH MOUNTAIN FSC:** 2—Jacqueline Lomra. Silver—Andrew Niebler.
- SOUTHPORT SC:** Pre—Ruth Principe. 1—Kelly Lynn Murphy, Shannon Stanton. 2—Christine Payson, Mimi Parker, Cindy Falstad. 3—Sandra Hens. Int FS—Karnie Rode, Sandra Hens, Carol Bisland, Lisa Ann Basil, Brian Peters.
- SOUTH TOWNS YMCA FSC:** Pre—Amy Fleissner. 1—Michelle Milanoski. Pre D—Michelle Milanoski. Bronze—Chris Ahrens. Pre-Silver—Beth Kushniruk.
- SC OF SPRINGFIELD:** 1—Jacqueline Stack, Bee Upham. 4—Laura Leaman. Juv FS—Jacqueline Stack. Pre-Silver—Laura Leaman.
- SQUAW VALLEY FSC:** 1—Tara Laferriere, Danelle Mcgettigan. 2—Kim Northrop. Juv FS—Sandy Denning.
- ST. CLAIR SHORES FSC:** Pre—Cynthia Kahle, Marcianne Sketch, Jamie E. Ghazal. 1—Leanne Walilko. 2—Alexander Miller, III, Debra L. Burns, Ann Karen McDonald, Kimberly Marsh. 3—Janice I. Nowak. Linda Litwin, Susan Trendell. 4—Peggy Brogan, Danielle Little, Lisa Ronchetto. Pre FS—Cindy Kahle, Marcianne Sketch. Juv FS—Susan Trendell, Elizabeth DePalma, Dora Friedel, Michelle Werner, Michelle Pelzel. Int FS—Megan O'Donnell, Jeffrey Olszewski. Nov FS—Sandra Flint, Danielle Little, Christie Bober. Pre D—Tracy Howe, Renae Hemler. Bronze—Linda Litwin, Isabelle Nicolae. Silver—Erica Davenport, Michelle Simon.
- ST. CLOUD FSC:** Pre—Amiee Buhr, Amy Daiker, Laura Fulayter, Sara Olson, Mary Radovich. 2—Chrissy Schlough. 4—Debbie Hill. 5—Patrick Smith. Pre FS—Amiee Buhr, Amy Daiker, Laura Fulayter, Molly Hilger, Sara Olson, Mary Radovich. Juv FS—Andrea Laylin, Marti Jo Gacusana. Int FS—Ann

Radovich. Pre D—Ann Radovich, Bridget Lieser.

ST. JOSEPH FSC: Pre FS—Margaret Waller.

ST. LAWRENCE FSC: Nov FS—April Sargent. Pre D—Julie Jaskowski, Kelly Mattice.

ST. MORITZ ISC: Pre—Tania Van De Wiel. 1—Keri Hitcher. 2—Lisa Erle, Terri Riley, Shawn Oda. 7—Donna L. Murakami. Pre FS—Tania Van De Wiel. Juv FS—Donna Chin, Norma A. Ramos, Wendy Earl, Lisa Erle, Kristin Mueller, Terri Riley, Michele Fosket. Int FS—Jennifer Longree.

ST. PAUL FSC: Pre—Pam Larson, Colleen Cummings. Pre FS—Amy Toconita, Elisa Sheppard. Juv FS—Christine Hayek. Int FS—Colleen Kent.

STOCKTON FSC: 4—Jeff Myers.

STONEHAM FSC: Pre—Louise M. Terciak. Pre FS—Louise M. Terciak.

SUNCOAST FSC OF FLORIDA: Pre—Sara Pierce, Patricia Sudduth, Adrienne Feldman, Jennifer Gardner. Pre FS—Sue E. Moseley, Heidi Busch, Sara Pierce, Terri Labuda, Shelly Ringold. Juv FS—Suzanne Pechuls, Lea Ann Ashmore, Linda Gordon, Patricia Sudduth, Adrienne Feldman, Missey Stover, Jennifer Gardner. Int FS—Melissa A. Jones, Patricia A. Hackbarth. Pre D—Carl L. Moseley. Bronze—Nancy Mae Nelson.

SC OF SUNRISE: Pre—Kristine M. Adler. Pre FS—Kristine M. Adler. Juv FS—Wendy Gargiulo.

SUN VALLEY FSC: Pre—Jennifer Smith, Cathleen F. Reynolds, Cindy Dwyer. 1—Gregory R. Dunfield. Pre FS—Margaret A. Reynolds, Heather Smith, Rio Glenn, Nevada Fine, Cindy Dwyer. Juv FS—Shannon Biszantz. Pre D—Allison Cairncross, Heather Smith, Suzy Biszantz, Jennifer Smith, Lisa Gache, Melissa Grether. Pre Silver—Zelda Leopold.

SYMMETRIC FSC: 2—Michael J. Reed, Jr.

SYRACUSE FSC: 1—Debbie Veniard, Marta Logusz, Michelle Macalalad. Juv FS—Debbie Veniard, Melissa Kelsesky. Bronze Pair—Michelle Macalalad.

TARA FSC: Pre—Jackie Auwarter. 1—Michelle Pettit, Andrea Simoni. 5—Cindy Dunaphant. 6—Robert L. Davis. 7—Debbie Sue Walls. Juv FS—Nicole Barnes, Dan Craft, Michele Shade, Tim Covington, Randi Beth Lowe. Nov FS—Cynthia L. Osborn. Jr FS—Maria Shupe. Bronze Pair—Christine Malacrea, Dutes L. Miller.

TAUNTON AREA FSC: Pre—Marie M. Murphy. Pre FS—Marie M. Murphy.

TRENTON COMMUNITY SC: Pre—Margaret Pauze. 1—Katie Hankin. Pre FS—Margaret Pauze. Juv FS—Katie Hankin.

TRI-CITIES FSC: Int FS—Shawn Rettstatt. Pre Silver—Shawn Rettstatt. Bronze Pair—Robyn L. Bryant.

TROY SC: Pre D—Sean Slack. Bronze—Mary L. Shaeffer, Anne Pittman, Valeria McLaughlin, Susan Pieper.

TULSA FSC: Pre—Julie Ann Forsythe, Lynn Newman, R. Sean Gales. 1—Theresa Jones, Allyson Dallman. 3—Leah R. Alford. 4—James Parker. 6—Christopher Sherrill. Pre FS—Tracey Westerman, Anne Pollard, Jennifer J. Johnson, Laura Jones, Rochelle Latimer. Int FS—Kirsten Whealy, Leah R. Alford.

UNION COUNTY FSC: Pre—Jennifer Sameth. Pre FS—Jennifer Sameth. Pre D—Jennifer Sameth. Silver—Anna Li.

UTAH FSC: Pre—Carol Lee Willis, Tom Burns. 5—Jon Jackson. 7—Patti Favero. Juv FS—Merrilee Rowland. Int FS—Jana Blackburn. Nov FS—Kurston Krantz.

VACATIONLAND FSC: Pre—Lucia Worth, Penny Wise, Nicole Ellingson. 1—Laura Worth. Pre FS—Nicole Ellingson.

SC OF VAIL: Pre—Sherrie Campbell, Christina Kelly. 1—Christina Kelly. 2—Christina Kelly. Pre FS—Christina Kelly.

SC OF VAN NUYS: Pre—Michelle Chao, Maggie L. Tuch. 4—Wanda Gene Leland. Pre FS—Michelle Chao, Maggie L. Tuch. Nov FS—Wanda Gene Leland.

WALLA WALLA FSC: 2—Sherry Danielson. 3—Richard Verburg. Int FS—Richard Verburg. Pre D—Sherry Danielson, Richard Verburg.

WARWICK FIGURE SKATERS: Pre—Pamela Hone, Tricia Altieri, Karen Stahowiak. 5—Lisa Demus, Dann Etchells, Rebecca Hatch. Pre FS—Pamela D. Orsi, Kellie Hart, Greta Hodgkinson, Pamela Hone, Tricia Altieri, Jennifer Wiggins. Nov FS—Lisa Demus.

IC OF WASHINGTON: Pre D—Kathleen X. Nelick. Bronze—Gary Sturm.

WASHINGTON FSC: Pre—James R. Hurd, Kristi Lattu, Elena Tomedden. 1—Phyllis Menge, Whitney An Wynters, Karen Lee McCormack. 2—Caryn Quinn, Lily Lee. 3—Beth Anne Brockner. 7—Diane C. Giamporcaro. Pre FS—Kristi Lattu, Elena Tomedden. Juv FS—Caryn Quinn, Jennifer Heppel, Bridget A. Barkeit, Lily Lee. 3—Beth Anne Brockner. 7—Diane C. Giamporcaro. Pre FS—Kristi Lattu, Elena Tomedden. Juv FS—Caryn Quinn, Jennifer Heppel, Bridget A. Barkeit, Lily Lee, Marica Fletcher. Jr FS—Lisane Sims. Pre D—Karen Metzler, Natasha Wideman. Bronze—James R. Hurd. Silver—Christine Smathers.

WAUWATOSA FSC: Pre—Thomas P. Wember. 2—Ann Newbauer. Jr FS—Jane Ellen Alioto.

WEST COVINA FSC: Pre—Brenda Tumey, Tracy Gonzales. 2—Vicki Lee, Michelle Lennon. 5—Cindy Herron, Colleen Hogan. Pre FS—Brenda Tumey, Tracy Gonzales. Juv FS—Vicki Lee, Michelle Lennon.

SC OF WESTCHESTER: Pre—Lynn Mahoney. Pre FS—Lynn Mahoney, Joanne Reilly, Karen Lockhart, Linda Beckel, Susan Pakula. Juv FS—Kristen Perin.

WESTMINSTER FSC OF ERIE: Pre—Beth Ann Arrowsmith, Elise Bellicini, Gretchen Hromyak. 1—Christen E. Cole. 5—Caryn Kadavy. Pre FS—Christine Swahn, Cheryl Kruth, Ruth Ann Madsen, Alyce

Send for FREE Catalog

SP Terri
SUPER-TERI
DELUXE

JOHN WILSON
BLADES



MK
BLADES

Riedell
ROYAL

WIFA
BOOTS

Phone and mail orders **WELCOMED!**
Same day shipment on items in stock

Inga, Polar Sport and TLC Skatewear
Martin, Peep and Spinner Scribes and Covers

3433 LEE ROAD, SHAKER HEIGHTS, OHIO 44120

(Circle No. 18 on reader service card)

Hennes, Kimberly Witt. Pre D—Christen E. Cole

WEST SHORE FSC: Pre—Erika Nelsen, Kimberly Huck, Laura A. May. 2—Laura Murdock. 3—Wendy Brewer. 5—Denise Nelson. Pre FS—Cindy Huck, Rachelle Miller. Juv FS—Ellen M. Punsalan, Elizabeth Punsalan Tanya M. Goverdovski. Int FS—Carolyn Kalus, Rita Marie Burger. Pre D—Carol Bauman, Denise M. Osur, Renee Reininger. Pre-Gold—Sherrin Fielder.

WHITE PINES FSC: Pre—Pamela Diamond. 1—Mary K. Payne, Deborah Diamond, Shawn Kurczewski. 2—Jennifer Menlen. Pre FS—Jennifer Garstecki. Juv FS—Shelly Riemer. Pre D—Marsha Diamond.

SC OF WILMINGTON: Pre—Maria Rodowski, Wendy Riggs. 2—Susan McKinstry, Dina Evans, Donnie R. Thorton. 5—Holly Anne Genola, Jody Boffa. 7—Lynne Freeman. Pre FS—Dori Kimmelalmn, Wendy Riggs. Juv FS—Susan McKinstry, Kristen Struck, Tom Hoffken, Wendy Riggs, Renee Oronzio. Nov FS—Kenny Bertino. Pre D—Wendy Riggs, Lynn Dillman, Stephanie Higgins. Pre-Silver—Barbara A. Easterday.

WILMINGTON FSC: 3—Christine Cooke, Mary Beth Thiel.

WINDY HILL SC: Pre—Kelly D. Villeskis. Juv FS—Kara M. Vanneman, Jennifer Cowen.

WINTERHURST FSC: Pre—Vicki Anagnostos, Susan Dzurec, Jennifer Heinert, Karen Crisafi. 1—Linda K. Casto. 2—Jackie Mueller, Laura Bell. 4—Jill Kinzie, Alison Chaney. 5—Teri Lee Lemmeyer, Anne Temesvary. Pre FS—Terri Prock, Susan Dzurec, Karen Crisafi. Int FS—Jill Kinzie, Laura Bell. Bronze—Bridget Scanlon. Silver—Leslie Southworth.

WISSAHICKON SC: 2—Allannah O'Toole. 3—Ethan Rogers, Jr. 7—Lucy Lennon. Pre FS—Margit Detweiler. Nov FS—Marci Levin.

SC OF WORCESTER: Pre—Carol A. Condon, Kimberly A. George, Heather Baird, Tracy A. Kinney. 1—Jennifer A. Ormondroyd. 2—Kim Saari. Pre FS—Carol A. Condon, Kimberly A. George, Tracy A. Kinney. Int FS—Deirdre E. Hanlon.

WYANDOTTE FSC: Pre—Chris Klafft. 1—Julie Fields, Pamela Goldsmith, Jill Weisenstein. 2—Darin Cooper, Jerri D. Dike. 4—Laura Jane Hinzman. 5—Monica Grunduski. Pre FS—Debra Kanode, Chris Klafft, Coelle Peck. Juv FS—Mary Chiles, Michelle Chapman, Shelly Tokarczyk. Int FS—Darin Cooper, Mindy McKelvey. Nov FS—Laura Jane Hinzman, Monica Grunduski. Pre D—Jerri D. Dike, Ginger Besasparis. Bronze—Michelle Chapman.

YARMOUTH IC: 3—Phoebe E. Pierce. 7—Susan E. Vogler. Int FS—Allyson Eddy.

(Continued on page 66)



THE GREAT SKATE
acknowledged by
GREAT SKATERS
since 1887

SEND FOR COMPLETE
BROCHURE.

Strauss
SKATES INC.

1751 East Cope Ave. ● St. Paul, Minn. 55109
(612) 770-1344

(Circle No. 19 on reader service card)



(Continued from page 12)

Elizabeth Jackson, WC of Indianapolis
Betty Bostwick, Birmingham FSC
Edward Reed, Kansas City FSC
Enid Larson, Blade & Edge of Omaha
Margie Cook, Utah FSC
Judith Guibor, Gateway/St. Louis FSC
Cathey Wetzel, FSC of New Orleans
Dulal Datta, Galleria FSC

INTERMEDIATE FIGURE

Arnold Savage, Rocky River FSC
Rebecca W. Rogers, Huntsville FSC
Gayle Edelman, Queen City FSC
Ilse Gould, Northcross FSC
Hope Harrold, Wichita FSC
Geoffrey Dean, Colorado SC

Split Jump Pillow Doll

**13" High
Blonde Yarn
Hair
Pink Check
Dress.**

Check, M.O.,
M.C., Visa,
Bk.Am., Am.X,
No C.O.D.



**\$10.98 plus
\$2.00 p.&h.
N.Y. add tax**

allow 3
wks.
for delivery

WRITE FOR OTHER SKATERS GIFTS!

Village Gallery Ltd.
518-523-4349
Hilton Plaza, Lake Placid, N.Y. 12946

(Circle No. 20 on reader service card)

HIGH FIGURE

Shirley Holdsworth, Hayden Recreation
Centre FSC
Julia Malfara, Wissahickon SC
Paula Jean Ziegler, SC of Boston
Margaret Flora, Portland ISC

GOLD FIGURE

Lester Cramer, M.D., Broadmoor SC
Monty Hoyt, Broadmoor SC
Nancy Bizzano, FSC of Minneapolis
Dr. Philippa Coughlin, Bridgeport SC
Helen Oak, Long Island FSC
Elliot Cohen, M.D., Long Island FSC

BRONZE DANCE

Marianne Diekman, Oak Park FSC
Hal Marron, Broadmoor SC
Cathey Wetzel, FSC of New Orleans
Cary Ann Walker, Bridgeport SC
James G. Peek, Atlanta FSC

SKATER'S JEWELRY

Now Available In Designer Enamel Pins

- Gold Pin White
Enameled Boots \$ 5.95
is Delux safety clasp
to be worn as pin, or
on a chain or as charm.
- Silver Pin Black
Enameled Boots \$ 5.95
Pinback is standard
safety clasp.

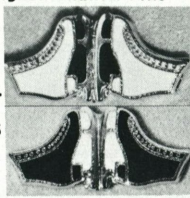

To order send Check
or M.O. to:
N.T. Paul
1210 Cleveland/Marquette, MI 49855
Other costume design enameled pins for clubs
& organizations are available on request.

Prompt Delivery
Add \$ 1.00 for P.&H.

Actual Size: 3/8" x 5/8"

(Circle No. 21 on reader service card)

Calendar *(Continued from page 7)*

MARCH

- 7 **Competition**, sponsored by the FSC of Watertown, at the Watertown Fairgrounds Ice Arena, Watertown, NY 13601. For information contact: Ronald Cole, 315-658-4739.
- 7-8 **Silver Blades Revue**, sponsored by the Hiawatha SC, at the Pullar Stadium, 435 E. Portage, Sault Ste. Marie, MI. For information contact: Mrs. Marcia White, Pres., 3670 Radar Road, Sault Ste. Marie, MI 49783, 906-635-5993.
- 14-15 **1981 Evelyn Boyer Memorial Invitational Competition**, 2nd Open Free Skating Competition, sponsored by the Old York Road SC at the Old York Road SC, Church & Old York Road, Elkins Park, PA 19117. For information contact: Mrs. L.R. Morris, 1111 Susquehanna Road, Rydal, PA 19046, 884-8524.
- 14-15 **Fantasy Iceland**, sponsored by the Camillus FSC, at Shove Park Rink, Camillus, NY. For information contact: Dottie Brooks, 315-672-3641.
- 14-15 **New England Juvenile Figure Skating Championships**, sponsored by the North Shore SC, at the Town Line Twin Rinks, 58 Andover St. (Rt. 114), Danvers, MA 01923. For information contact: Mrs. Catherine Kirchner, 85 Forest St., Danvers, MA 01923, 617-774-0578.
- 20-21 **Southern New Hampshire Ice Revue 1981**, sponsored by the Southern New Hampshire SC at the J.F.K. Coliseum, Manchester, NH.
- 20-22 **13th Annual Nassau County Freestyle and Precision Teams Championships**, sponsored by the Cantiague FSC, at the Cantiague Park Rink, West John St., Hicksville, NY 11801. For information contact: Helene Raile, Secretary, 52 Ridge Dr., Plainview, NY 11803.
- 25-29 **17th Niagara Invitational Competition**, sponsored by the Buffalo SC, at the Buffalo SC, Buffalo, NY.
- 26-29 **"Ice Travaganza '81,"** 9th annual ice show, sponsored by the Wyandotte FSC, at the Benjamin F. Yack Arena, 3131-2nd St., Wyandotte, MI 48192. For information contact: Mr. Robert Lokuta, 2294-23rd, Wyandotte, MI 48192, 313-285-1942.
- 27-28 **Annual Ice Show**, sponsored by the FSC of Watertown, at the Watertown Fairgrounds Ice Arena, Watertown, NY 13601. For information contact: Ronald Cole, 315-658-4739.
- 27-29 **Annual Ice Show**, sponsored by the Clinton FSC, at the Clinton Arena, Clinton, NY 13323. For information contact: Mr. Robert Galliher, Chairman, 315-736-9273.
- 27-29 **Cleveland Invitational Championship**, sponsored by the Garfield Heights FSC, at the Dan Kostel Recreation Center (formerly the Garfield Heights Recreation Center), 12001 Tonsing Dr., Garfield Heights, OH 44125. Free Style Competition. For information contact: Mrs. Helen Lindway, Pres., 5535 Cumberland Dr., Garfield Heights, OH 44125, 216-475-8438.
- 27-29 **WIM Competition**, sponsored by the Greater Milwaukee FSC, at the Wilson Park Recreation Center, Milwaukee, WI. Figure, Freestyle, Dance, and each separately. For information contact: Mr. Ralph Dahlmon, 414-282-3948.
- 28 **North Yarmouth Academy FSC Show**, at the Cumberland County Civic Center, Portland, Maine. For information contact: Linda Andrews, 40 East Elm Street, Yarmouth, ME 04096, 846-4151.
- 28-29 **"New York, New York,"** an ice show sponsored by the Charter Oak FSC, at the Veterans Memorial Skating Rink, 56 Buena Vista Road, West Hartford, CT. For information contact: Mrs. Sue Mollineaux, 477 Salmon Brook St., Granby, CT 06035.

APRIL

- 2-4 **6th Annual Heart of America Competition**, sponsored by the Kansas City FSC, Iceland South Arena, Overland Park, Kansas.
- 3-5 **1981 Ice Spectacular, 30th Annual Show**, sponsored by the North Shore SC, at the Town Line Twin Rinks, 58 Andover St. (Rt. 114), Danvers, MA 01923, Mr. James Kirchner, 85 Forest St., Danvers, MA 01923, 617-774-0578.
- 3-5 **Meet Me in St. Louie Dance Weekend**, sponsored by the Gateway/St. Louis FSC, at the Brentwood Park and Recreation Dept., 2505 Brentwood Blvd., Brentwood, MO 63144. For information contact: Mr. William R. Boeck, Jr., 15 Rosemar Lane, Glencoe, MO 63038, office 314-343-4900, home 314-458-2272.

(Continued on page 65)

KID TALK

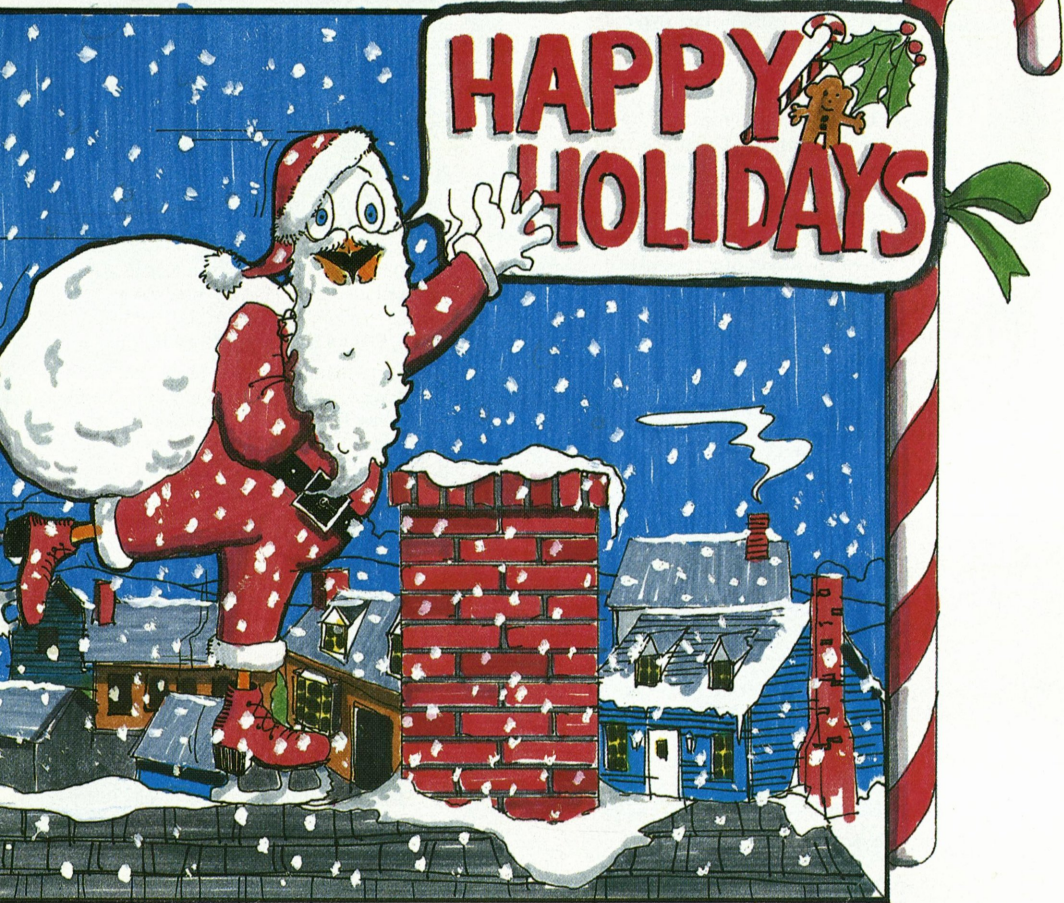

(ANSWER ON NEXT PAGE) ▶

PICTURE SCRAMBLE

This month's picture scramble was sent in by JACKIE GEARY & KIM ALLARD of W. Covina, Calif. Thanks!

If anyone else has an idea for picture scramble send them to KID TALK.

Dear Kid Talk,
I am 13 years old, and skate at Wornjelleo Ice Arena. I am working on axle, Double Salchow, and split jump. My favorite spins are hayback, flying camel, and sit spin. My pro is Kirk Bateman. I will be in my first competition Oct 26. I really enjoy your book, it's great!!

Happy Skating!!

Samantha Shults
Bloomfield Colo.





Tina

There once was a girl from Massena,
 Who went to the cold Arena,
 She tried a loop jump..
 And fell on her rump,
 And that was the end of Tina.

By Mia Medina
 Massena N.Y.
 Massena Figure Skating age=11

Thanks to: Mia Medina
 of Massena N.Y.
 Age: 11 Massena F.S.C.

WHAT SKATING MOVE IS THIS?

CLUE: ANOTHER
 NAME FOR A
 BLANKET.

by Tracy Galetti Age 12 ▶
 of W. Covina F.S.C.
 P.S. Hi Beth!

Snoopy

T.G. 10-2

CLASSIFIEDS

CLASSIFIED RATES: \$15 for the first 35 words, 50¢ for each additional word, \$15 minimum. Two-letter state abbreviation code plus zip code count as one word. *Payment required with order.* All advertising copy is subject to acceptability. BOX NUMBERS: \$5 extra. Send all box responses to SKATING, Box - 20 First Street, Colorado Springs, Colo. 80906.

SKATING MOTHERS DEFRAY expenses by representing FIGURES. Sell 100% wool two-piece warm-up suits and carrying cases for boots and scribes. See ads November and December SKATING. Write FIGURES, Box 5251, Berkeley, CA 94705.

MAKE YOUR OWN DASHING SKATE DRESS: Multi-size patterns include flat or full front, overlap, pleated, full and pleat-insert skirts. Short, long, straight, puffed sleeves. Scoop, turtle, square, V-neck-lines. Straight or V-shaped skirt lines. Adaptable for jumpers with darts and zipper. Girls (4-12) pattern \$6.95, Ladies (4-14) pattern \$7.95. All new Step-In Dress Patterns: For Lycra or Spandex only without zipper. Scoop neck, flat front with full back or full skirt, 4 semifull or 4 full panels for back skirt, straight sleeves. Panty with skirt is sewn onto top to make one piece dress in 2½ hrs. Girls, Ladies S-4-6, M-8-10, L-12-14 \$4.00 each. 160 exciting modern, geometric, ornate, borders and floral designs for decorating Skate dresses with Beads or Rhinestones. Instructions and ideas included. \$12.95 per book. Postage & handling included in prices. Skate-Stag, 8212 Ammons Cr., Arvada, CO 80005, Jutta I. Payne (303-423-7098) Send check or M.O., Allow 3-4 weeks for book only.

SPECIAL SALE on our 10th Anniversary, unique skating antique and gift items, discount up to 40%: figurines, plates, tiles, bells, out-of-print books, old wooden skates, . . . Something special for everyone. Buy now for X'mas, New Year, Valentine's Day, Birthday, . . . Send \$1.00 for illustrated catalog and price list now. Club and Dealer Inquiries also welcome. TOM KUO'S SKATIQUES, P.O. Box 554, Milldale, CT 06467.

FREESTYLE PROGRAM RECORDED cassettes. Pre through senior music. \$5.00 to \$15.00. For musical titles write Master Tape, 1627 S. Tejon, Colorado Springs, CO 80906. 303-473-2188.

USA OLYMPIC HOCKEY jerseys. Polyester. White or Blue. Sewn Crest. Double color numbers. \$42.00 postpaid. S, M, L, XL. KLB Hockey Centre, 714 Y Contra Costa, Pleasant Hill, CA 94523.

ICE DANCERS READ Origins of Ice Dance Music, by Muriel Kay. U.S. \$4.95. Limited Edition Reprint of Key to Rhythmic Ice Dancing, by Muriel Kay. U.S. \$6.00. Add 50¢ handling per book. NEW - The CHA CHA. \$1.00 + 25¢ pstg. FROM Muriel Kay. P.O. Box 98164, Tacoma, WA 98499.

SCIENTIFIC ASSESSMENT OF skating skills: Analysis of high speed film, physical and physiological measurement, multi-disciplinary conference by Biomechanics Team in Delaware. Complete or partial testing available. Dr. M. Turner, Douglass College, New Brunswick, NJ 08903.

WANTED: EX ICE Show Skaters—and others—you must be agile and able to handle yourself on a 21' x 20' surface of real ice. Free to travel on short tours. Send photos, resume, first letter to Buddy LaLonde Ice Classic's, 3777 Quinlan Ln., San Jose, CA 95118—(Jean Peterson from St. Paul and Charles Douglas Girl from San Diego, please contact me).

"HOW TO" recreational skating book. 70 skills described—90 photos. For individual use or class text. Dealer & Pro inquiries invited. Send \$4.50 plus 50¢ handling to: Ice Skating Guide, P.O. Box 211, West Newton, MA 02165.

STOCKING STUFFERS—Wooden figurines \$1.50, lucite skate key chain \$8, blade & boot covers \$6 - \$8, Cloisnone Skate pens, \$2.75, Love-A-Judge—\$3, CFSA Poster—SK skate with red roses \$2.25, Quiana pull on & wrap skirts, \$15 & \$12. Stationery 70¢ - \$2.25, Mice on Skate Wrapping Paper \$1.25. The Serpentine, 2191 Kensington, Buffalo, NY 14226. 716-839-5284.

WANTED: MALE DANCE partner, 5'10" or over, must have passed pre-silvers or higher. Will work under gold test pro. Send inquiries to 2017 Wetton, Marquette, Michigan, 49855.

TRAINING HARNESS designed and developed by skaters' for skaters safety. Prevent dangerous falls, have complete control of skater while in jumps. Develops Form, Doubles, Triples and Higher jumps. Comp. unit \$850.00. For information call 714-280-9906. Write, HARNESS 4335 39th. St., San Diego, CA 92105.

NATIONAL GOLD MEDALIST seeks petite female 5'2" or under for Gold Dance Competition to train with top East Coast pro. Will consider free or pair skater with dance background. Send resume: Skating, Box 211, Woodbridge, NJ 07095.

SKATING ARTIST—Realistic drawings of your favorite figure skater (famous, friend, family or even yourself.) Watercolor, black and white, pastel pencil. Send photo if you wish. For information—Christine Rutkowski, 38075 Bainbridge Road, Solon, OH 44139.

WORLDS: VIDEO TAPE of all events. Place your order for specific event. Dance (Free Dance, Compulsory), Pairs (Short & Long Program), Mens, Ladies (Short & Long Program). Carlan Photo Service, 35 Mill Road, Irvington, New Jersey 07111, 201-372-6000.

THE SKATER'S PATCH Shop. Only the best is stocked. Wifa and Riedell Boots, Wilson Blades, Polar Sports. Inga — Jane — Figures — Margo — Dresses galore. Scribes and everything you need.

Call or write Joan Devitt. Olympic Arena, Lake Placid, NY 12946. 518-523-3325 — 518-523-2365.

LOOK GREAT, SKATE GREAT. Spandex dresses and bodysuits for practice and competition. Readymade solids and prints. Girls, Boys and Adult sizes. For information and swatches call 203-795-5727. Write PATCHCO 686 S. Greenbrier Drive, Orange, CT 06477.

TREAT YOURSELF TO your own special creation for the holidays. Complete instructions for skating outfits, appliques to designer gowns, designs to embroider, bead, or paint. Sample applique. Send \$3.50. To purchase the complete book, w/pages of various designs, send \$7.95 plus \$1.00 for shipping & handling to: Vahona's Variations, 732 Scorpio Circle, Colorado Springs, CO 80906.

HAPPINESS IS . . . LAST MINUTE gift package specials from M & M. We'll even enclose a gift card from you to whomever, for you. 1) A navy, blue or ivory tote bag, filled with a Tshirt of your choice, a 14K gold-plated key tag and a luggage tag, \$26.86 value for only \$22.95. 2) A silver and gold special; a 24K gold-plated Bijan fillagree figurine, a 14K gold-plated key tag and a silver-plated collectors spoon, a \$62.91 value, for only \$49.95. 3) A photo album, Good Luck bell and a magnetic-kinetic figure skater, \$21.91 value, for \$18.95. Guaranteed Christmas delivery. Please send \$2.50 handling and your order today to: M & M Distributors, 15081 Syracuse St., Westminster, CA 92683. All of our items are available at regular price too, and our complete catalog is only \$1.00.

DELTA FIGURE SKATING CLUB (12 miles S. of Vancouver, B.C) requires a Senior Coach commencing September, 1981. 30 Hrs. per week winter ice — pre-school through competitive level. Spring and Summer ice in Vancouver. Membership over 500. Must take responsibilities of head coach, have gold figure and free and be choreographically proficient to direct a carnival. Send resume to Delta Figure Skating Club, c/o 5132 Winskill Dr., Delta, B.C. CANADA, V4M 2C8.

THE ORIGINAL LEG-ANN'S legwarmers. Six basic colors & sizes. Special colors or sizes available. Machine washable and dryable. Now sold in five states. Dealer inquiries also welcome. Leg-Ann's, 2574 Freeport Road, Rockton, IL 61072. 815-624-2448.

CUSTOM MADE DRESSES for the beginner and competitive skater at reasonable prices. For more information and samples of material send \$1.00 to JO-ANN'S, 165 St. Camille St., Fitchburg, MA 01420.

PATTERNS & COMPLETE instructions to sew ice and roller boot covers, includes all sizes, send \$2.75 to: SKATEMUFFS, Box 211, W. Newton, MA 02165. Also available: ready-made covers and kits — free brochure — dealer inquiries invited.

FUND RAISERS, figure skating clubs, pro shops, dealers, professionals—Beautiful, inexpensive, profitable SKATE/mate quality jewelry, stationery; great for awards, gifts, ice competitions, ice shows. Brochure to above groups. SKATE/mate, Box 264 H, Orange, NJ 07051.



NON QUALIFYING COMPETITIONS

**NEW ENGLAND INTERCLUB FREESTYLE
& DANCE COMPETITION
BURLINGTON, MASSACHUSETTS
JULY 12 & 13, 1980**

PRELIMINARY GIRLS A

1. Sara Jeanne Powell, SC of Boston
2. Wendy Millette, Colonial FSC
3. Kelly Connolly, Winchester FSC

PRELIMINARY GIRLS B

1. Jennifer Ormondroyd, SC of Worcester
2. Laura Azzara, Smithfield FSC
3. Christine Marie Dupont, Wallace FSC

PRELIMINARY GIRLS C

1. Kendra Driscoll, North Shore SC
2. Amy Sochrin, New Haven SC
3. Elaine Dupuis, SC of Hingham

PRE-JUVENILE GIRLS A

1. Carolyn Burke, Winchester FSC
2. Cari-Lynn Copetas, Colonial FSC
3. Kara Anne Rossi, Winchester FSC

PRE-JUVENILE GIRLS B

1. Lynne Marie Leger, Colonial FSC
2. Diana Pepper, Smithfield FSC
3. Christine Cusick, New Haven SC

PRE-JUVENILE GIRLS C

1. Beth Tick, Mass Bay SC
2. Karen Marie Mazzola, SC of Worcester
3. Lisa Conley, Mass Bay SC

JUVENILE GIRLS A

1. Kim Tarasuck, Mass Bay SC
2. Sally Northrop, Colonial FSC
3. Kathleen Brooks, Pilgrim SC

JUVENILE GIRLS B

1. Paulee Mercier, Yarmouth IC
2. Lizbeth Kuraska, Little Sun Valley SC
3. Lori Morello, Mass Bay SC

JUVENILE GIRLS C

1. Katie Brownlie, Colonial FSC
2. Linda Mamulski, SC of Amherst
3. Kimberly Ann Morse, SC of Amherst

INTERMEDIATE GIRLS A

1. Patricia Ann Layden, Colonial FSC

2. Kirstin Rauhauser, Silver Blades SC
3. Jill Irving, Falmouth FSC

INTERMEDIATE LADIES B

1. Julie Ann Morse, Colonial FSC
2. Sharon Voroschak, New Haven SC
3. Allison Rosen, Hayden Recreation FSC

INTERPRETIVE JUVENILE

1. Donna Balesteri, North Shore SC
2. Amy Kirchner, North Shore SC
3. Karin Bullerwell, Mass Bay SC

INTERPRETIVE INTERMEDIATE

1. Kerri Lynn Bell, Smithfield FSC
2. Susy Houston, Colonial FSC
3. Natalie Orne, Winchester FSC

INTERPRETIVE NOVICE

1. Cori Suzanne Krane, North Shore SC
2. Erin McCarthy, SC of Worcester
3. Ellen Williams, North Shore SC

BEGINNER ADULT

1. Constance Gagnibion, Colonial FSC & Charles Gagnibion, Colonial FSC
2. Deidre Rees, Colonial FSC & Christopher Rees, Charles River FSC

NOVICE SOLO

1. Cori Suzanne Krane, North Shore SC
2. Debra N. Huber, Colonial FSC
3. Laura Ann Edmunds, Yarmouth IC

PRELIMINARY ADULT

1. Pauline Burton, Wilmington FSC & Robert P. Rafuse, Colonial FSC
2. Bobbe Miner, Silver Blades SC & Michael Olsen, Smithfield FSC
3. Barbara Walsh, Wilmington FSC & Daniel Barnat, Colonial FSC

INTERMEDIATE SHADOW

1. Melissa DiLoranzo, Smithfield FSC
Cindy Lotito, Smithfield FSC
2. Kimberly Ann Morse, SC of Amherst
Lisa Hamilton, Greenfield Area FSC
3. Joan Eicher, Colonial FSC
Dawn Eicher, Colonial FSC

INTERMEDIATE ADULT

1. Elaine Savoy, SC of Boston
Frank Tieuli, Mass Bay SC

2. Patricia Roche, Charles River FSC
Robert Rafuse, Colonial FSC
3. Joan Eicher, Colonial FSC
Douglas Tang, Colonial FSC

JUNIOR SOLO

1. Cori Krane, North Shore SC
2. Debra N. Huber, Colonial FSC
3. Sharon Whittemore, SC of Amherst

NOVICE ADULT

1. Elaine Savoy, SC of Boston &
Frank Tieuli, Mass Bay SC
2. Diana Goldman, Bay Path SC &
Michael Rokes, Comet FSC
3. Debra Huber, Colonial FSC &
Daniel Barnat, Colonial FSC

INTERMEDIATE SOLO

1. Kimberly Ann Morse, SC of Amherst
2. Dawn Eicher, Colonial FSC
3. Patricia Brunner, Colonial FSC

JUNIOR ADULT

1. Diana Goldman, Bay Path SC & Michael
Rokes, Comet FSC
2. Debra Huber, Colonial FSC & Daniel
Barnat, Colonial FSC

JUNIOR INTERPRETIVE

1. Cori Krane, North Shore SC
2. Sharon Whittemore, SC of Amherst
3. Missi Stockwell, Smithfield FSC

VETERANS

1. Patricia Roche, Colonial FSC, & Chester
Teichman, Colonial FSC
2. Pauline Burton, Wilmington FSC &
Robert Rafuse, Colonial FSC

NOVICE SHADOW

1. Debra N. Huber, Colonial FSC &
Dianne M. Huber, Colonial FSC
2. Laura Ann Edmunds, Yarmouth IC &
Wendy Lee Weston, Yarmouth IC

OPEN ADULT FINAL

1. Elaine Savoy, SC of Boston & Frank
Tieuli, Mass Bay SC
2. Diana Goldman, Bay Path SC & Michael
Rokes, Comet FSC
3. Debra Huber, Colonial FSC & Daniel
Barnat, Colonial FSC



PERFECT CIRCLE
Adjustable Patch Marker
The Spinner. . \$50.00
Choice of color trim
Enscribed owner's name
Carrying Case. . \$9.50
Calif. residents add 6% Tax

Send for complete brochure
FRANK DAVENPORT
Box 43, Orinda, California 94563
(415) 254-5067

(Circle No. 22 on reader service card)

ICE DANCE MUSIC

ALL TAPES SERIES 1 & SERIES 2

DANCE PROGRAMS - One hour each
Each tape overlapping in dances included but progressively more advanced.

Low.	\$28.00
Intermediate.	\$28.00
High	\$28.00

COMPULSORY DANCE SET

One hour - Preliminary through gold with two extra dances \$28.00

COMPULSORY DANCE MIXED

Same music, dance program format. . . \$28.00

PRACTICE LESSON SET - One hour each

One test category per side, 3 to 4 tunes run consecutively for each dance.

Preliminary - Bronze	\$28.00
Pre-Silver - Silver	\$28.00
Pre-Gold - Gold	\$28.00

Any three one hour tapes \$80.00

PRACTICE CASSETTES - 30 minutes each

8 cassettes available. One test tempo per 15 minute side. 5 to 6 different tunes per side.

Each cassette	\$13.00
Entire set of eight.	\$95.00

Cassette prices as listed above.

Open reel types and prices on request

Prices include fourth class mailing. For further information or to order, check or money order to:

Ice Dance Enterprises, Inc.
P.O. Box 23, Beaverton, Oregon 97075

(Circle No. 23 on reader service card)

calendar

(Continued from page 59)

APRIL

- 3-5 **Tri-State Free Skating Competition**, sponsored by the Detroit SC, to be held at the Detroit SC, 888 Denison Court, Bloomfield Hills, MI 48013. For information contact: Mr. William T. Mocerri, 11000 Capital, Oak Park, MI 48237, 313-541-2640.
- 4-5 **New Jersey Council Figure Skating Association's Annual Free Skating and Dance Competition**, hosted by the SC of Morris, at the William G. Mennen Sports Arena, Morristown, NJ. Only open to resident and club members of New Jersey.
- 10-11 **"U.S.A.-Today,"** ice show sponsored by the Amherst SC, at the Audubon Recreation Center, 1615 Miller-sport Hwy., Williamsville, NY 14221. For information contact: Deborah Gehrke, 95 Briarhill Road, Williamsville, NY 14221, 694-8805.

Advertisers' Index

C	
Cass's Sports Center	43
Centre Ice	4
D	
Darrah Cooper Jewelers	45
Designs by Margarita	11
F	
Fi8ures	55
Frank Davenport	65
I	
Ice Dance Enterprises	65
Ice Dancing Illustrated	67
Ice Follies	49
Inga	8
Inside Edge	40
J	
Jan-Pro	55
M	
Martin & Co.	6
M & M Distributors	12
N	
Natalie Paul	58
1981 National Championships	OBC
Nicholls Sports	57
R	
RLS Products	49
Rainbo Sports Shop	14
Riedell Boots	IFC
S	
Skate Tape	28
Strauss Skates	58
T	
Town of Vail	45
U	
USFSA Rulebook	29
V	
Village Gallery	58
W	
Walnut Hill School	47

LAURELS *(Continued from page 57)*

INDIVIDUAL MEMBERS: Pre—Kathy Gilfillen, Gail Luxton, Billy Brennan, John Stackhouse, Melissa Allan, Shelly Logar, Lori N. Watrous. 1—Kimberly A. Hall, Kelly C. Mack, Lauren B. Harris, Bobbie J. Wyatt. 2—Laura Hall. Pre FS—Alice Vasquez, John Stackhouse, Melissa Allan, Janice L. Baker, Sharon K. Schneider, Lori N. Watrous. Juv FS—Suzanne Izatt, Donna Sheldon, Kimberly S. Jepsen. Int FS—Helene K. Jesnig. Jr FS—Kathleen Doolan. Bronze—Denise Warburton, John Stackhouse. Pre-Silver—Kyra Lowther. Silver—Cynthia E. Smithers. Pre-Gold—Pat Stokowski.

PROFESSIONALS: 2—Timothy Zech. 4—Sara Perry. 7—Hilary Potts. Pre FS—Paul Pepp, Susan Stec. Jr FS—Emily O'Brien. Bronze—Terese Brownlie. Silver Free—Jamie Morgan.

AVAILABLE TODAY . . . THE FIRST BOOK OF ITS KIND . . .

by Lorna Dyer. United States Ice Dance Champion.
Twice North American Ice Dance
Champion. Silver World Medalist.
And veteran teacher.

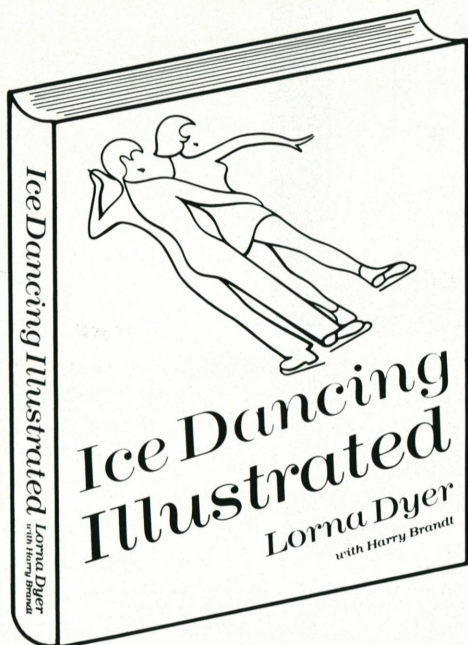

Included are:

- action oriented photographs
- introduction to all dances
- Ravensburger Waltz
- solo and couple instruction
- tracking (partner positioning)
- knee action for each dance step

Hard bound, over 300 pages, 370 photos.

Ice Dancing Illustrated

represents the most contemporary statement in instruction for compulsory dances. Autographed copies available now for Christmas giving.

Send \$25.00 in U.S. Currency, \$29.50 Canadian
Currency to:

MOORE PUBLICATIONS, INC.

1720 - 130th AVENUE N.E. • BELLEVUE, WASHINGTON 98005 • (206) 881-7575

(Circle No. 24 on reader service card)

FOR A NATIONALS WITH SUN AND FUN IT'S SAN DIEGO IN '81

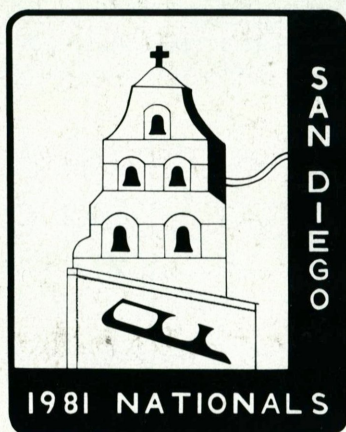

SAN DIEGO SPORTS ARENA February 1-8, 1981



Sanctioned by the United States Figure Skating Association
Co-Hosted by the San Diego Figure Skating Club
and the Women's Auxiliary to Children's Hospital and Health Center

FOR ALL-EVENT TICKETS
IN PREFERRED SEATING SECTIONS @ \$55 EACH
Send checks made payable to 1981 Nationals to:

Betty Nickols
2354 Plum Street
San Diego, CA 92106

For information on accommodations, please write:

Patricia Oates
4874 Donaldson Drive
San Diego, CA 92109